

DO NOT SLIDE THE SIDEBOARD INTO POSITION

Axton sideboard Assembly Instructions

Warnings

Please keep these instructions for future reference.

Please do not stand or sit on your furniture.

When unboxing, use the packaging as a protective surface to prevent damage.

Please periodically check fittings and tighten if necessary.

Please keep children away from the construction area and from small fittings.

This item is very heavy and requires 2 people to lift.

Once fully assembled, do not attempt to drag the unit into situ, lift the item as shown, to avoid any damage.

We Recommended

We suggest you to read through and fully understand instructions before getting started.

Please check that all components are included before assembly.

We recommend that you assemble this piece in the room intended for use.

Please ensure you have sufficient space for construction.

Please ensure the product is fully assembled as indicated within these instructions and that all fittings are tightened before use.

Not Recommended

Please do not drag furniture, dragging can damage joints.

Please do not allow children to climb on furniture

Number of people required to assemble



HEAVY

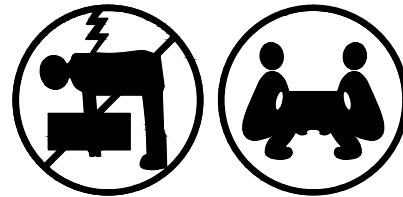

Time to assemble

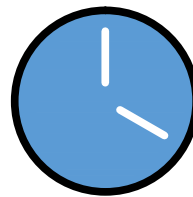

20 Minutes

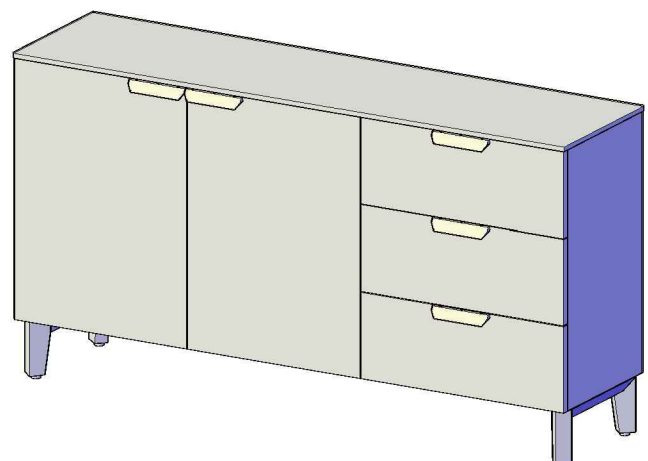

DO NOT SLIDE THE SIDEBOARD INTO POSITION

Axton sideboard Assembly Instructions

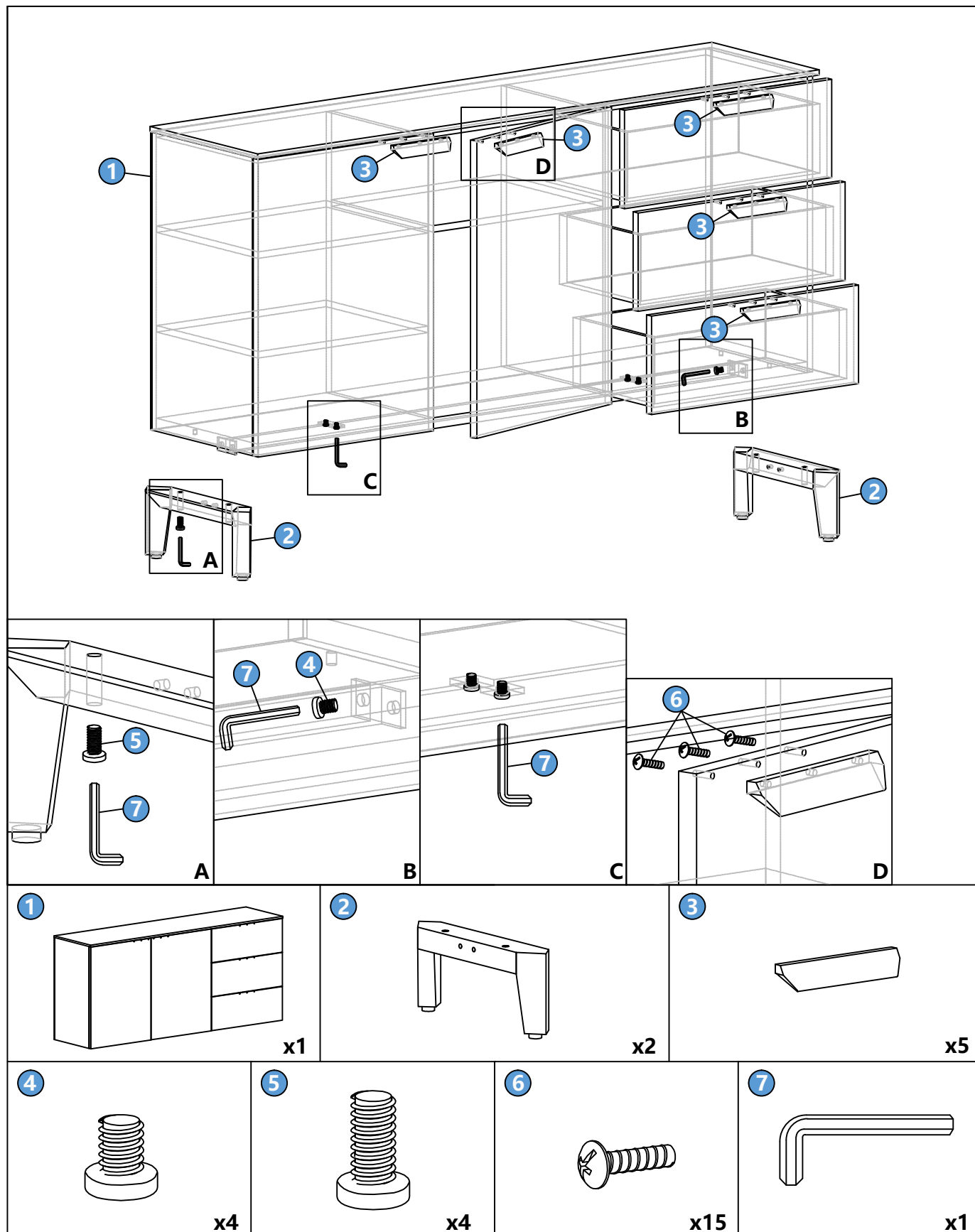

DO NOT SLIDE THE SIDEBOARD INTO POSITION

Axton sideboard Assembly Instructions

Step 1

Attach two legs to the sideboard using fittings (5).



Only hand tighten bolts until step 2

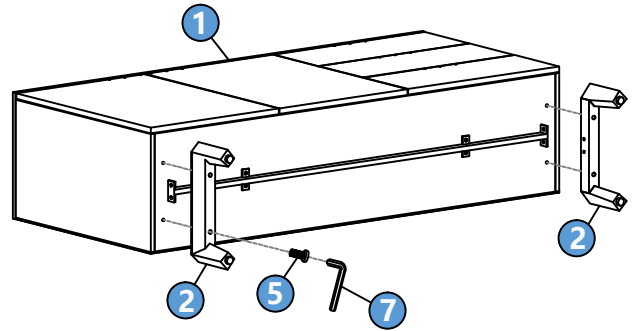

Step 2

Attach two legs to the connecting rod using fittings (4).



Fully tighten bolts

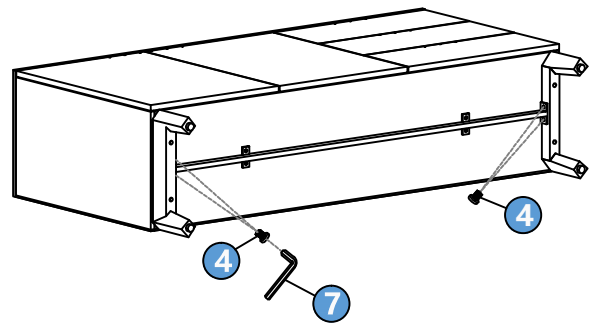

Step 3

Tighten all bolts completely using the tools provided.

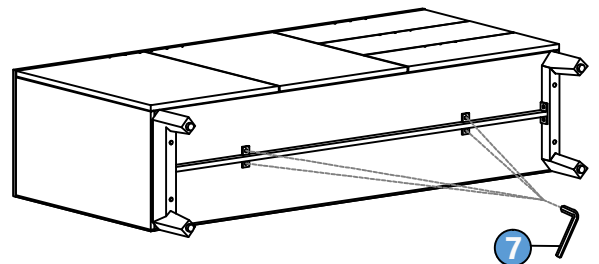

DO NOT SLIDE THE SIDEBOARD INTO POSITION

Axton sideboard Assembly Instructions

Step 4

Attach five handle to the sideboard using fittings (6).

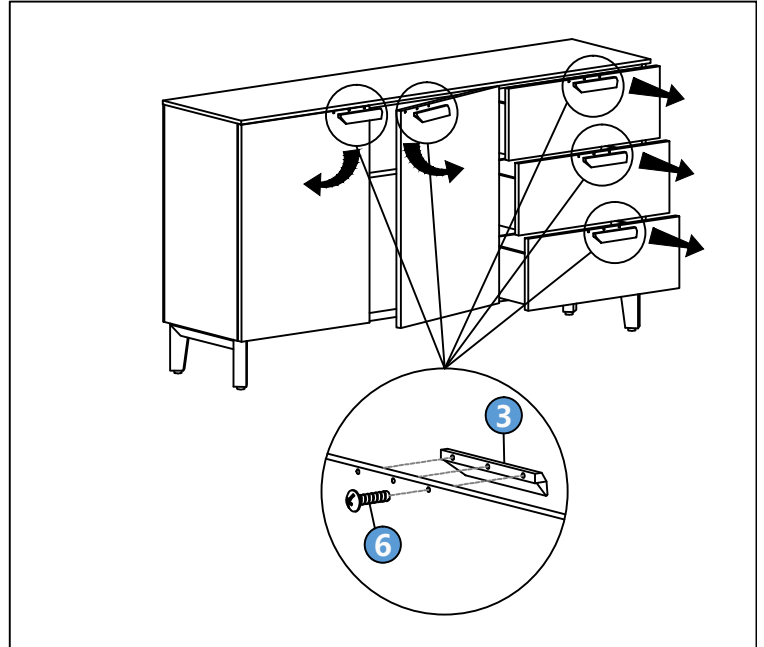

Step 5

There are small adjustable feet on the bottom of the legs, to ensure the tables can be made level.

Your Sideboard is now complete

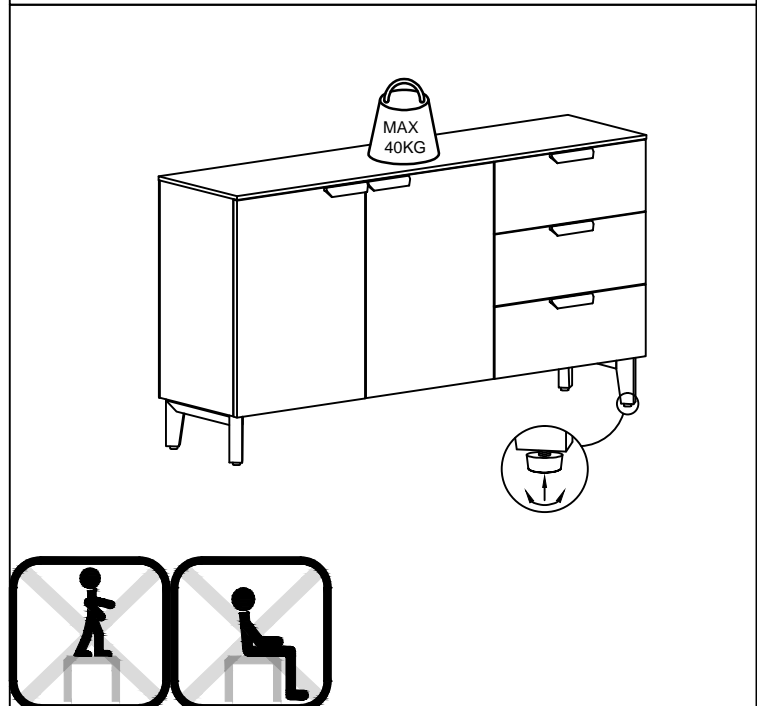

Safety Caution: Please do not sit, lean or stand on the edge of the table.

DO NOT SLIDE THE SIDEBOARD INTO POSITION

Axton sideboard Operation Instructions

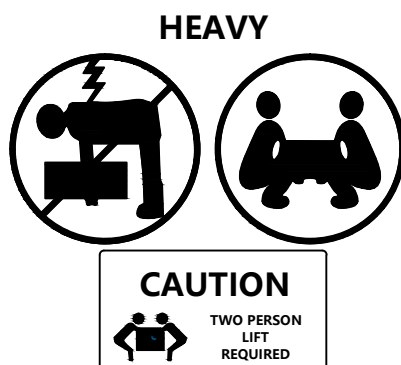

Warnings

This item is very heavy and requires 2 people to lift. Once fully assembled, do not attempt to drag the unit into situ, lift the item as shown, to avoid any damage.

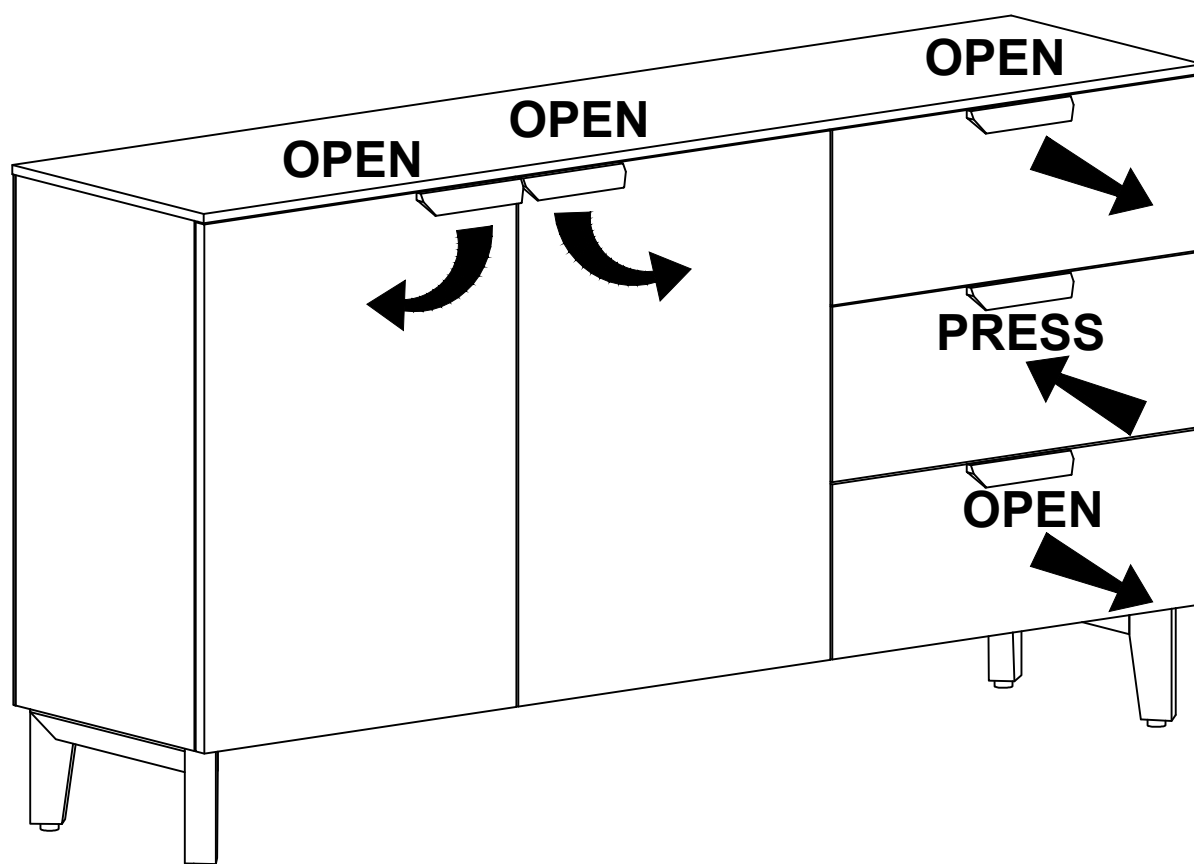

DO NOT SLIDE THE SIDEBOARD INTO POSITION

HEAVY

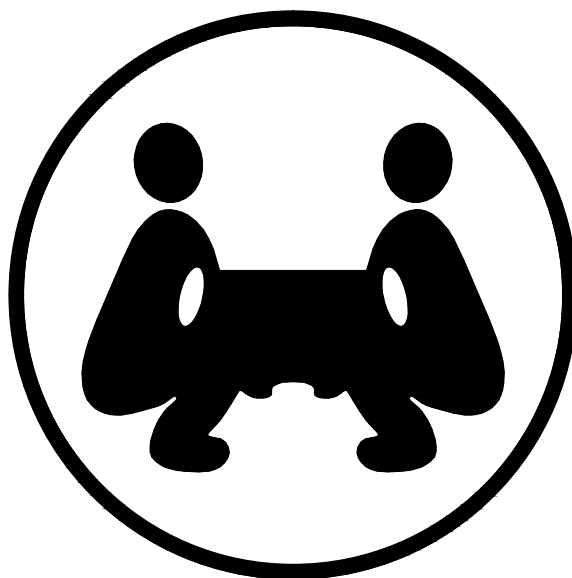
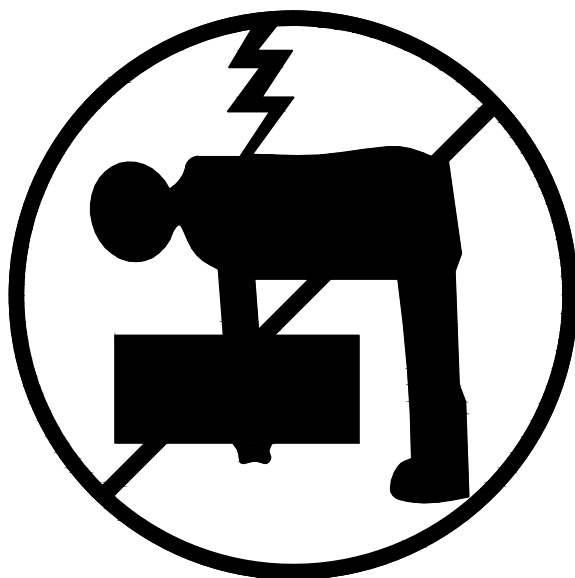

CAUTION



**TWO PERSON
LIFT
REQUIRED**

Warnings

This item is very heavy and requires 2 people to lift. Once fully assembled, do not attempt to drag the unit into situ, lift the item as shown, to avoid any damage.

DO NOT SLIDE THE SIDEBOARD INTO POSITION

Door Panel Adjustment Instruction

The doors are normally fitted and adjusted at the factory, however during transportation & handling, the doors may become 'misaligned', please follow below 'adjustment instructions', to realigned the doors.

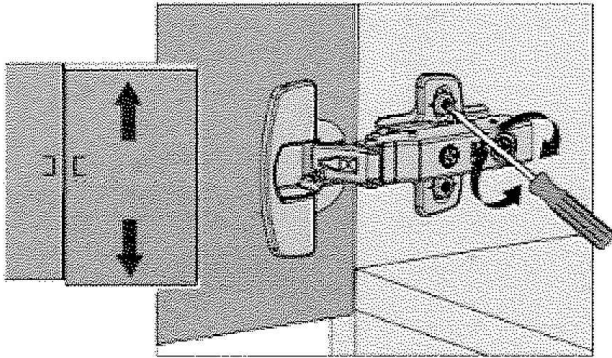

VERTICAL
HINGE HEIGHT ADJUSTMENT

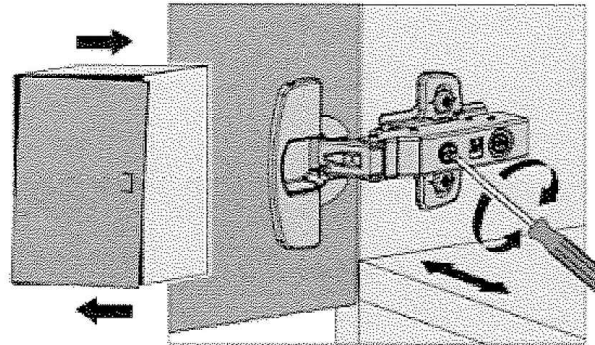

HORIZONTAL
HINGE SIDE ADJUSTMENT

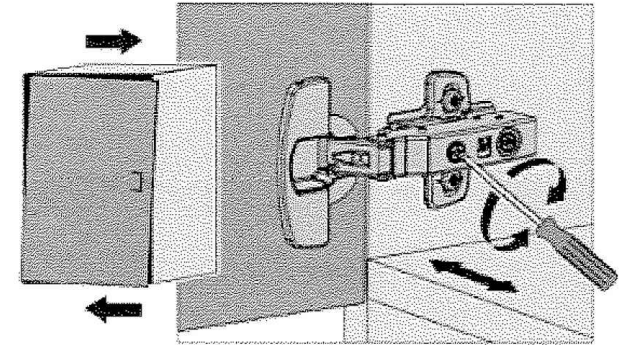

IN/OUT
HINGE DEPTH ADJUSTMENT

Please Note:

Avoid overtightening the adjustment screws.

Ensure that your furniture is on a level surface.

To keep your new product looking great, occasional maintenance may be required. During use and transportation, doors and drawer fronts may become slightly misaligned - to create the best look please follow the instructions above.

DO NOT SLIDE THE SIDEBOARD INTO POSITION

How to Adjust the Drawers (if required)

Please Note:
Avoid overtightening the adjustment screws.
Ensure that your furniture is on a level surface.

1. Horizontal Adjustment

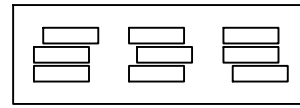

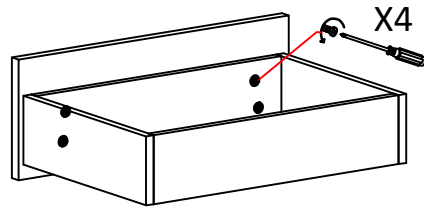

Phillip Screwdriver

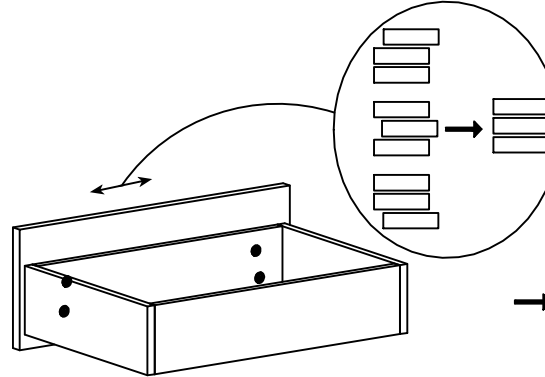

Loosen screws

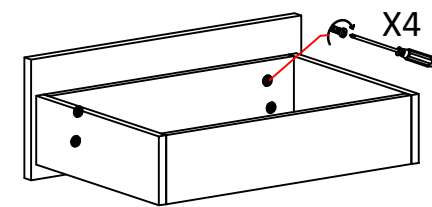

Move drawer front left or right as required



Tighten screws

2. Vertical Adjustment

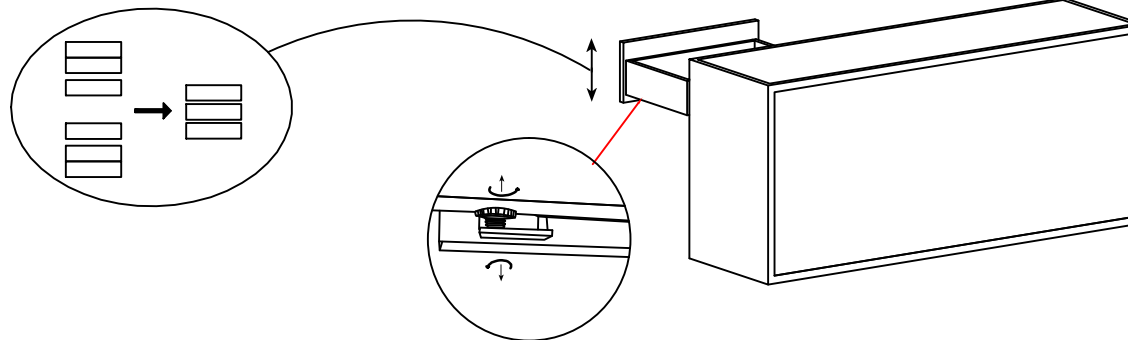

Turn bolts clockwise or counterclockwise to move drawer up or down as required

To keep your new product looking great, occasional maintenance may be required. During use and transportation, doors and drawer fronts may become slightly misaligned - to create the best look please follow the instructions above.

DO NOT SLIDE THE SIDEBOARD INTO POSITION

How to Adjust the Drawers (if required)

Please Note:
Avoid overtightening the adjustment screws.
Ensure that your furniture is on a level surface.

3. IN/OUT Adjustment

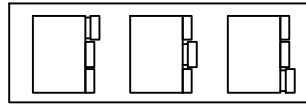

Phillip Screwdriver

①

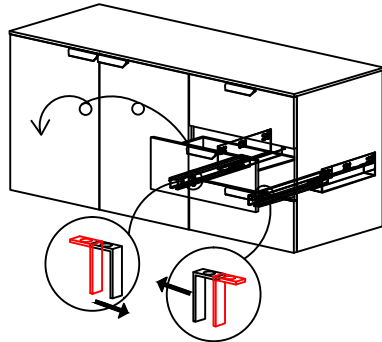

Pull out the white plastic positioner under the drawer and take off the drawer unit.

③

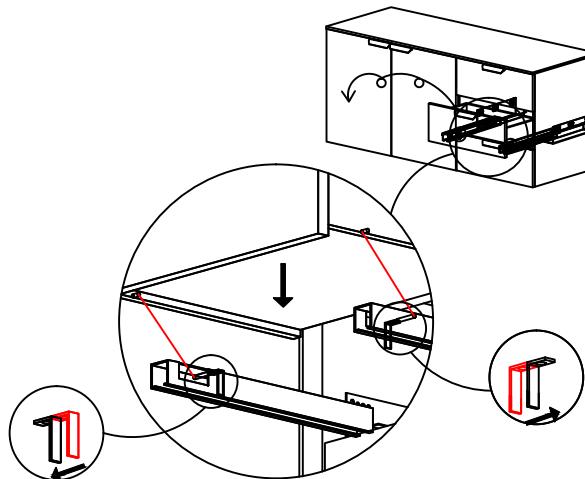

Put the drawer back on the slide, fix the drawer again with the white plastic positioner

②

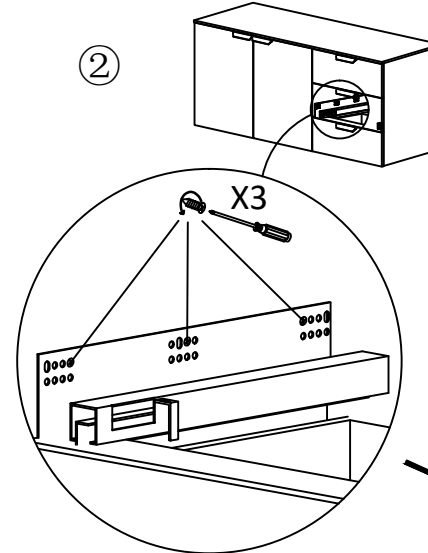

Loosen screws

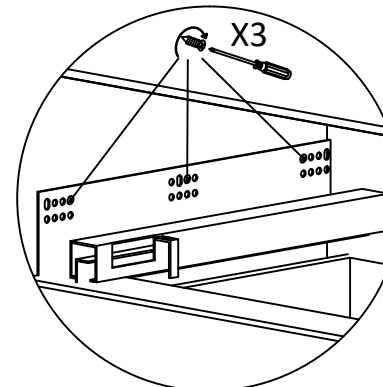

Tighten screws

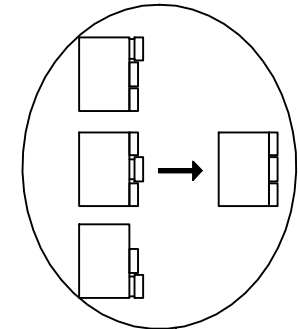

Move sliding rail inward or outward as required

To keep your new product looking great, occasional maintenance may be required. During use and transportation, doors and drawer fronts may become slightly misaligned - to create the best look please follow the instructions above.

DO NOT SLIDE THE SIDEBOARD INTO POSITION

How to Handle & Lift your sideboard with Care

1. Indoor Handling

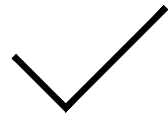
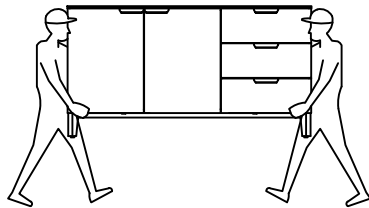

The sideboard is heavy, 2 people required to lift and maneuver into place.

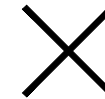
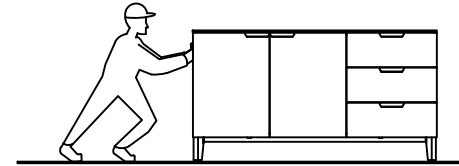

Do not slide the sideboard into position. You will run the risk of damaging the furniture.

2. Outdoor Handling

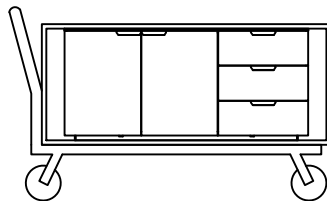

Always move the furniture unassembled without the feet.

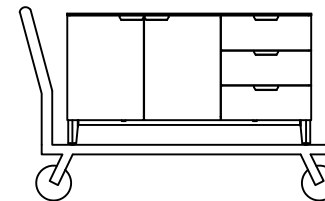

Do not move with the feet fully assembled, you run the risk of damaging the furniture.