

ASSEMBLY INSTRUCTIONS JUNO ROUND PLANT TABLE 1177-304

Top Round Plant Table (A)=1pc

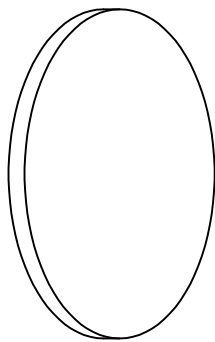

LEG = (B) = 1 Pcs

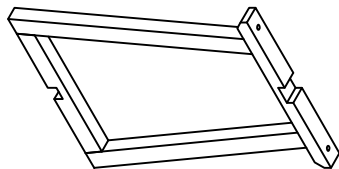

LEG = (C) = 1 Pcs

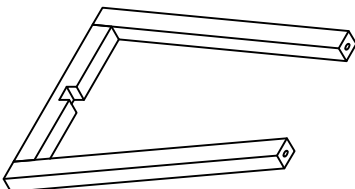

LEG = (D) = 1 Pcs

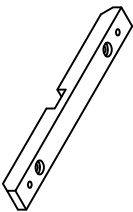

Hardware List

No	SKETCH	DESCRIPTION	QTY
1		Bolt M6 x 40	4 pcs
2		Lock washer M6	4 pcs
3		Flat washer M6	4 pcs
4		Allen Key M4	1 pc

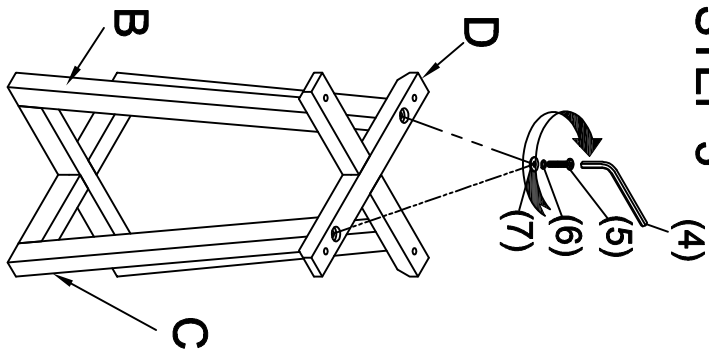

Step By Step Assembly Instructions
PRE-ASSEMBLY PREPARATION
1. Before you begin to assemble your new piece of furniture, please check to ensure that all parts have been supplied.
2. Follow instruction closely as deviation from them may void your warranty and present a possible safety risk.
3. It is recommended that assembly is done on a soft surface like carpet to avoid any damage.
4. The fitting pack contains small items which should be kept away from young children.

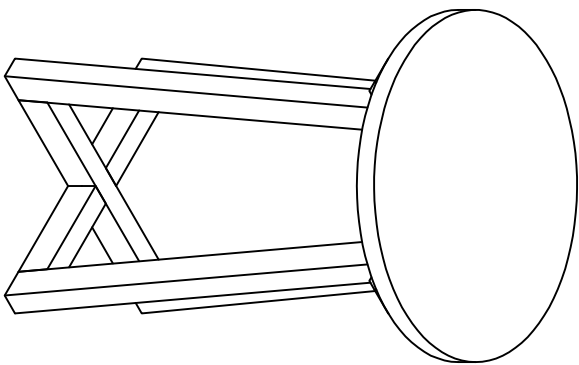
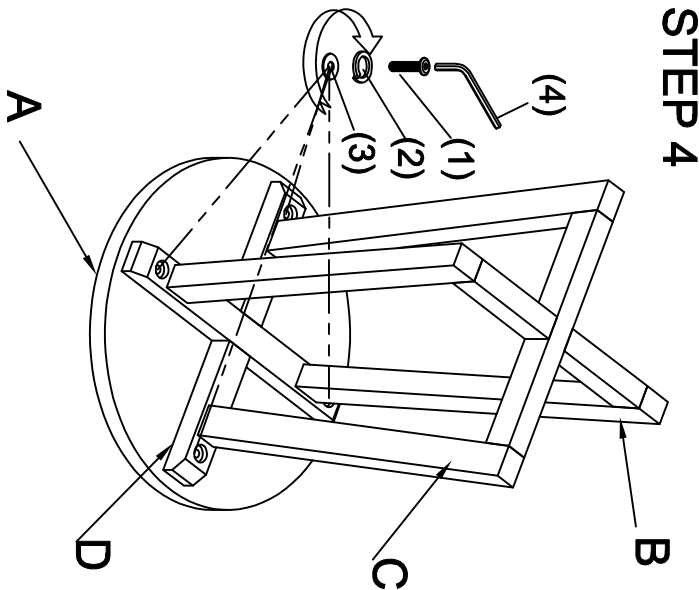
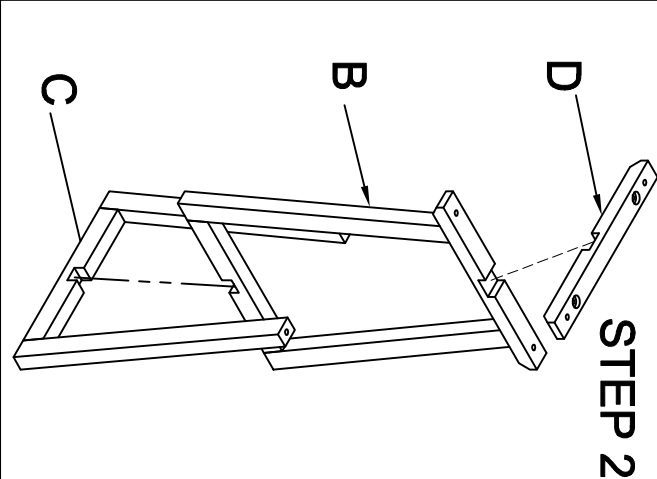
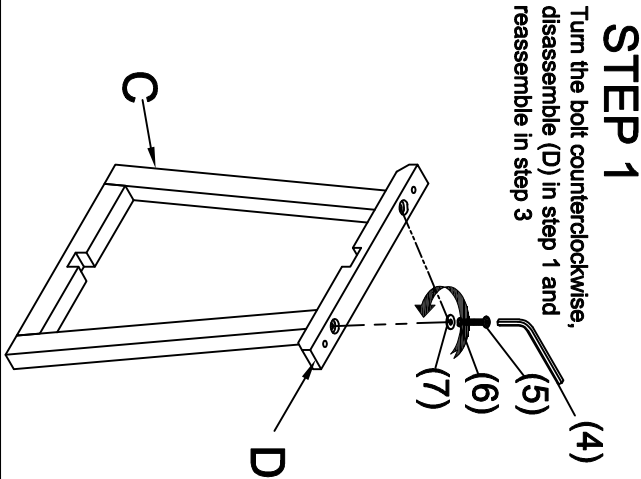

MADE IN VIETNAM