

ALEXIS

Made Exclusively for

Harvey Norman®

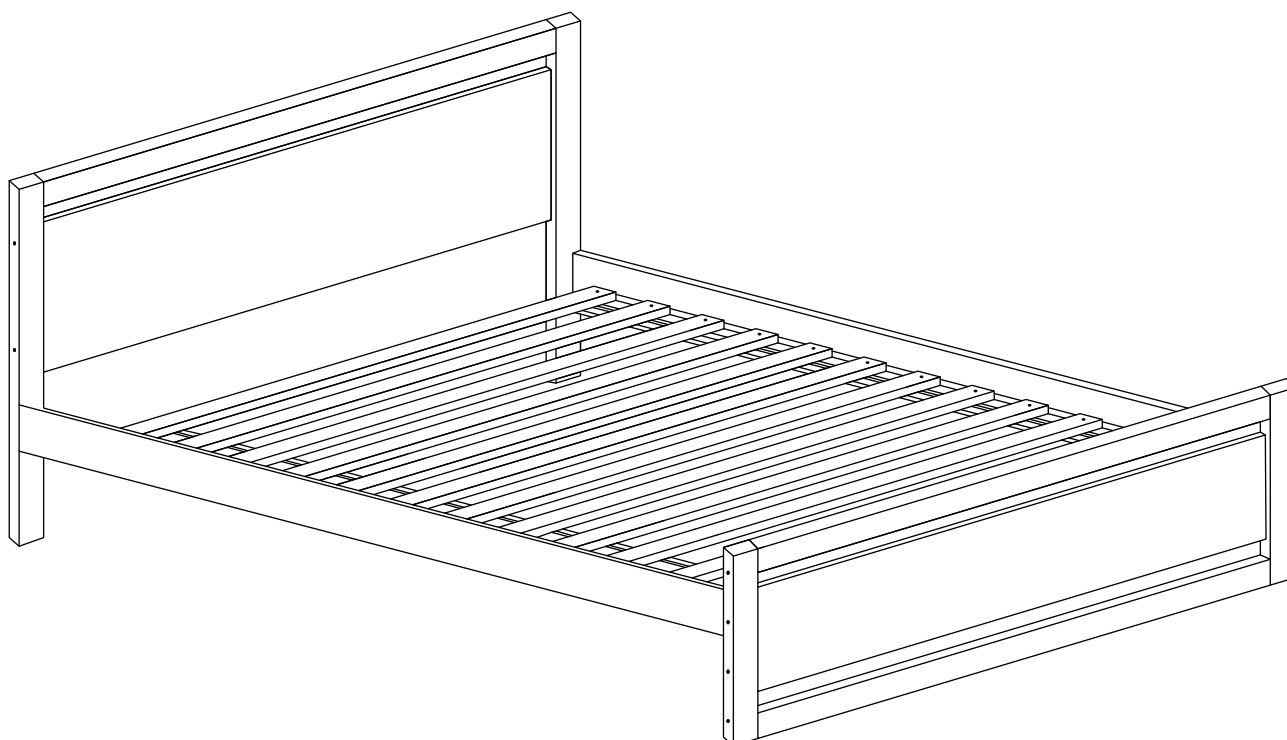

ASSEMBLY MANUAL

MODEL: ALEX/BF3FT, ALEX/BF4FT & ALEX/BF4FT6

LIST OF AVAILABLE ASSEMBLY PARTS

A



Head & Foot Board
Horizontal Rail
x 03

B

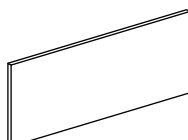

Head Board Panel
x 01

C

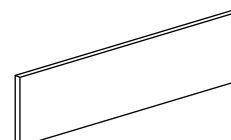

Foot Board Panel
x 01

D

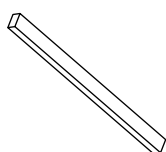

Head Board Post
(Left & Right)
x 02

E



Foot Board Post
(Left & Right)
x 02

F

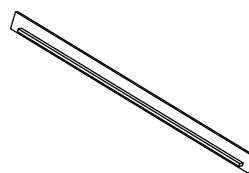

Side Rail
x 02

G

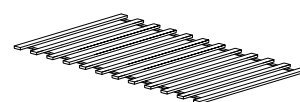

Slats
x 12

1

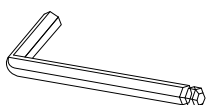

Allen Key M4
x 01

2



Jcbc M6 x 90MM
x 14

3



Jcbc M6 x 60MM
x 08

4



Dowel M10 x 30MM
x 22

5



Barel Nut M6 x 15MM
x 22

6

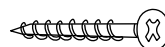

Screw M4 x 25MM
x 24

7



Wood Button
x 22

REQUIRED TOOLS

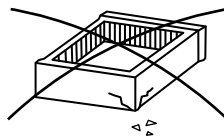
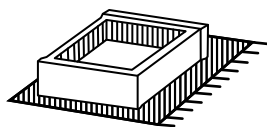
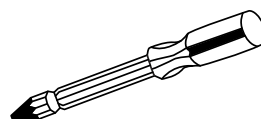
30 MINUTES**TWO PEOPLE****SCREWDRIVER**

ASSEMBLY TIPS

1. Remove hardware from box and sort by size.
2. Please check to see that all hardware and parts are present prior of assembly.
3. Please follow attached instruction in the same sequence as numbered to ensure fast and easy assembly.



WARNING!

- Do not recommend the use of power drills/drivers for inserting bolts/screws as this could damage the unit.
- Do not over tighten the nuts or bolts as this will cause damage to the thread
- Keep all parts out of the reach of children

STEP 1

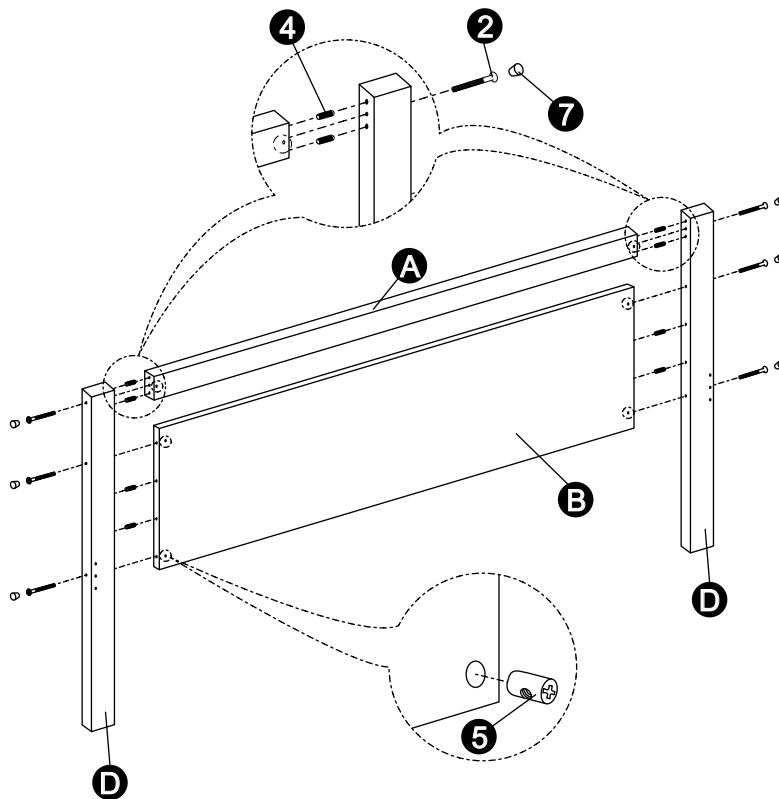

STEP 2

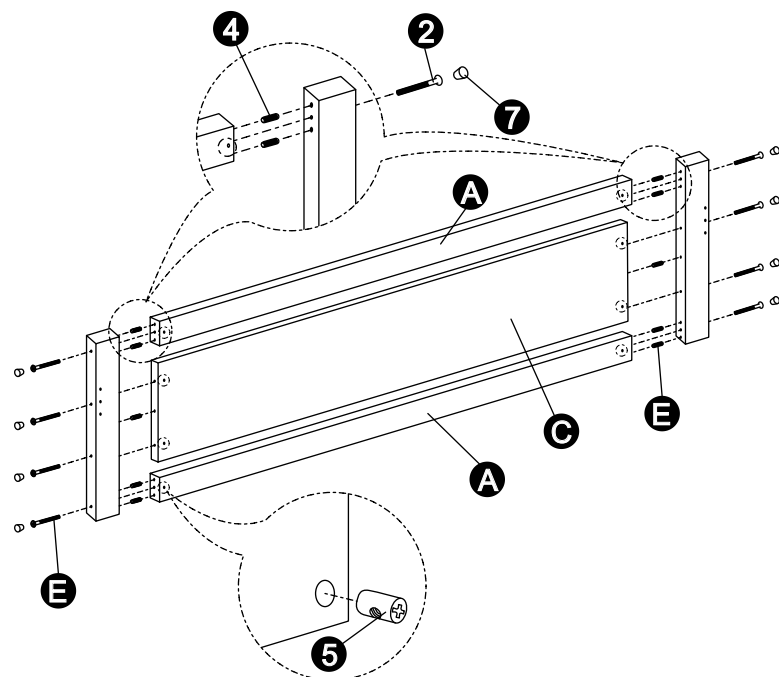

STEP 3

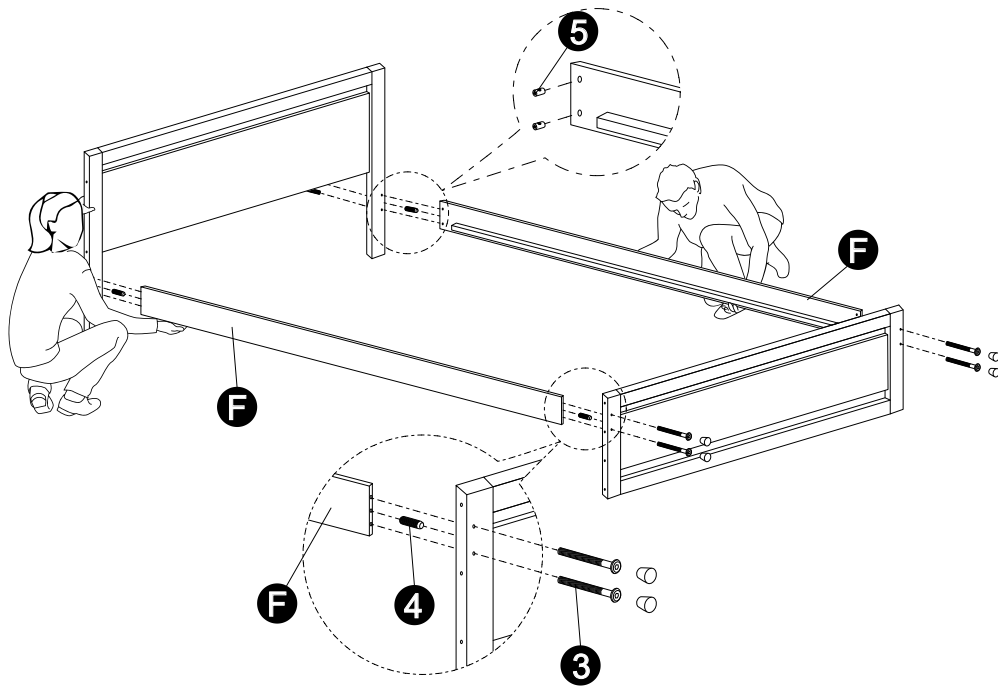

STEP 4

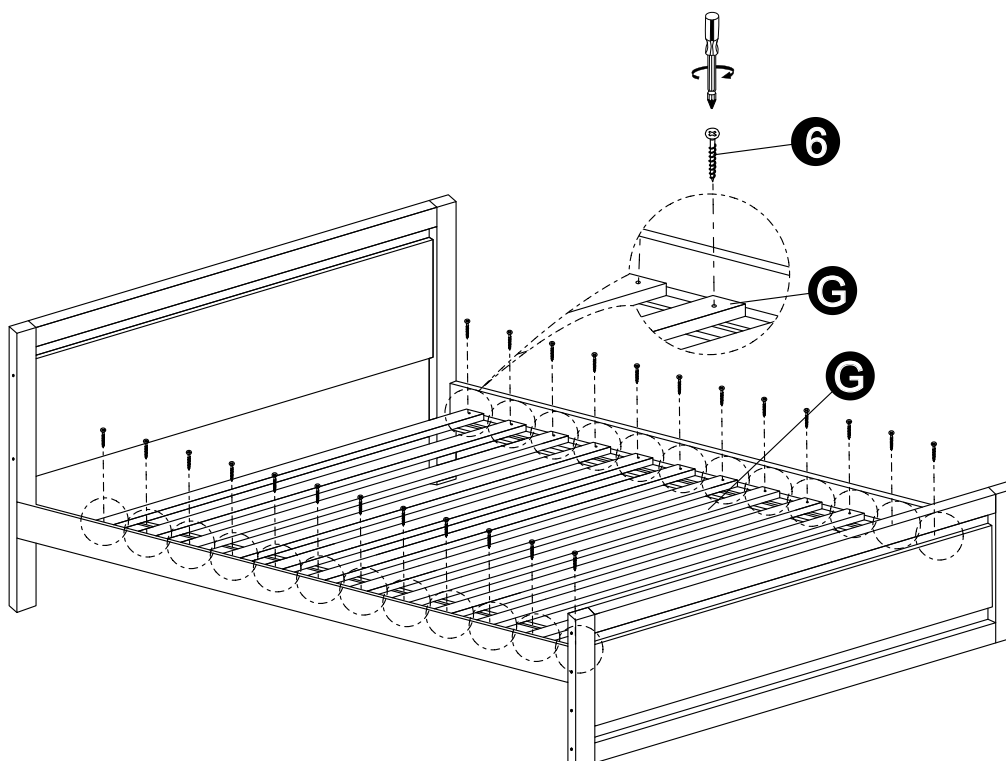

FINAL STEP

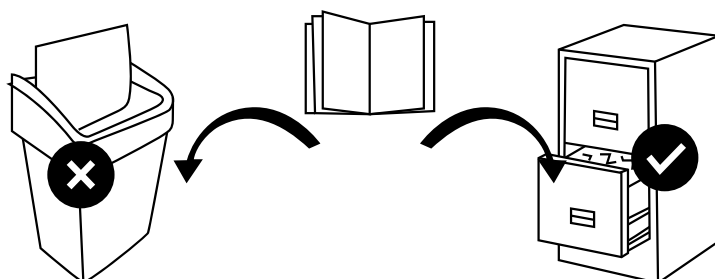
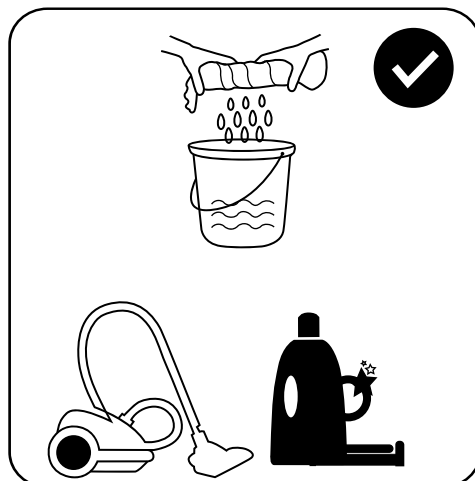
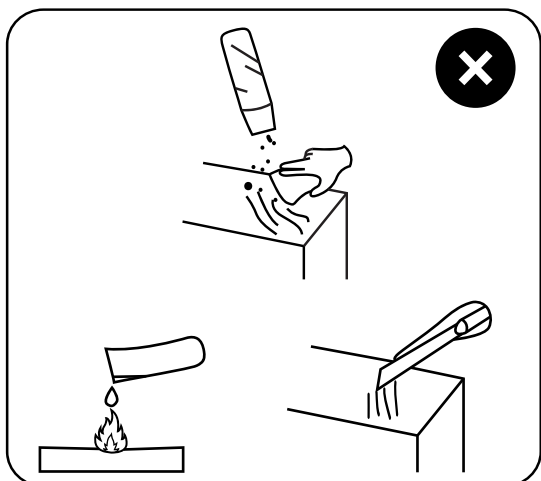

FOR TIPS ON HOW TO CARE FOR YOUR PIECE

Please refer to our Care & Maintenance Guide in stores and online