

EZRA TRUNDLE

Made Exclusively for
Harvey Norman[®]

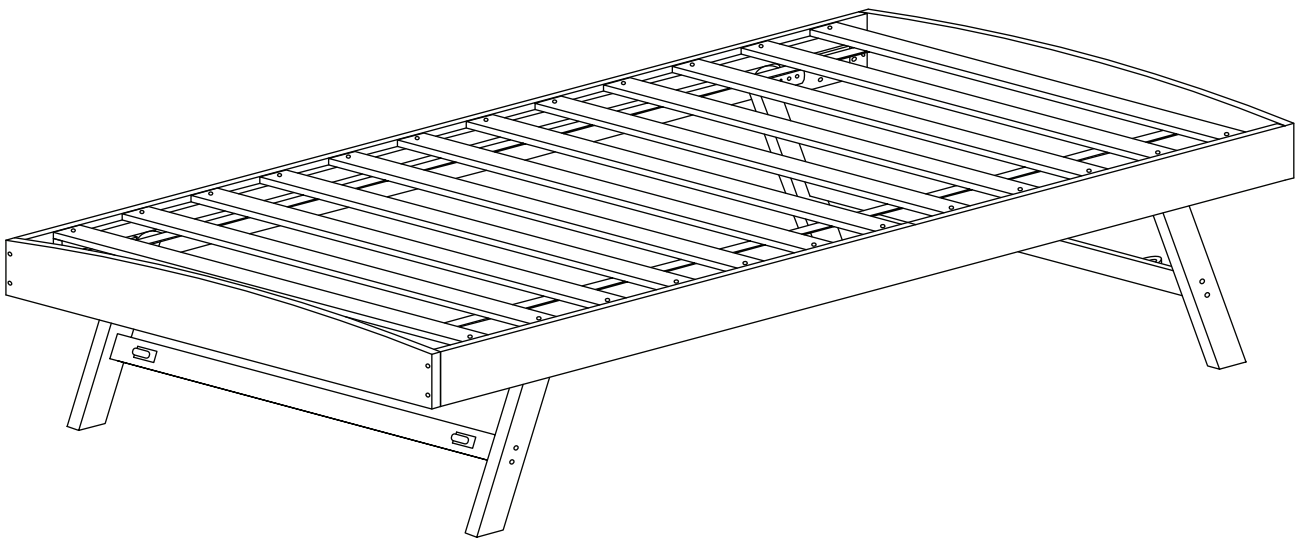

ASSEMBLY MANUAL

MODEL: 

LIST OF AVAILABLE
**ASSEMBLY
PARTS**

A

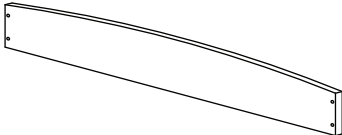

Head board
x 02

B

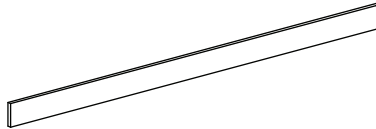

Side Rail
x 02

C

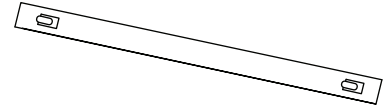

Horizontal Wheel bar
x 02

D

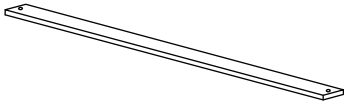

Slats
x 01

1



BARREL NUT 6 X 15mm
x 16

2

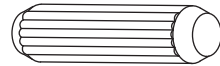

WOOD DOWEL 10 X 30mm
x 04

3

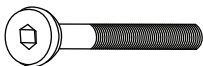

BOLT JCBC M6 x 60mm
x 16

4



CSK SCREW 4 x 25mm
x 24

5

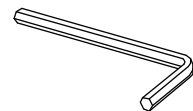

ALLEN KEY M4
x 1

REQUIRED TOOLS

30 MINUTES



TWO PEOPLE



SCREWDRIVER

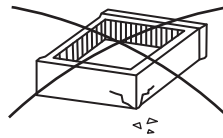
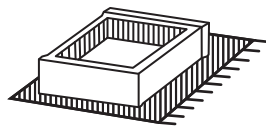
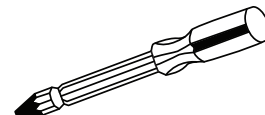

ASSEMBLY TIPS

1. Remove hardware from box and sort by size.
2. Please check to see that all hardware and parts are present prior of assembly.
3. Please follow attached instruction in the same sequence as numbered to ensure fast and easy assembly.



WARNING !

- Don't attempt to repair or modify parts that are broken or defective. Please contact the store immediately.
- This product is for home use only and not intended for commercial establishments.
- Two persons are required for assembly.
- Approximate assembly time : 1/2 hours.
- Component parts and fittings contained in the box.

Please sort out all parts before you begin to assemble the item.

This is to make sure you always use the correct part.

- ALL SLATS MUST BE INDIVIDUALLY SCREWED INTO SIDERAILS TO ENSURE STRUCTURAL INTEGRITY OF YOUR BED

EZRA TRUNDLE

Made Exclusively for **Harvey Norman**

STEP 1

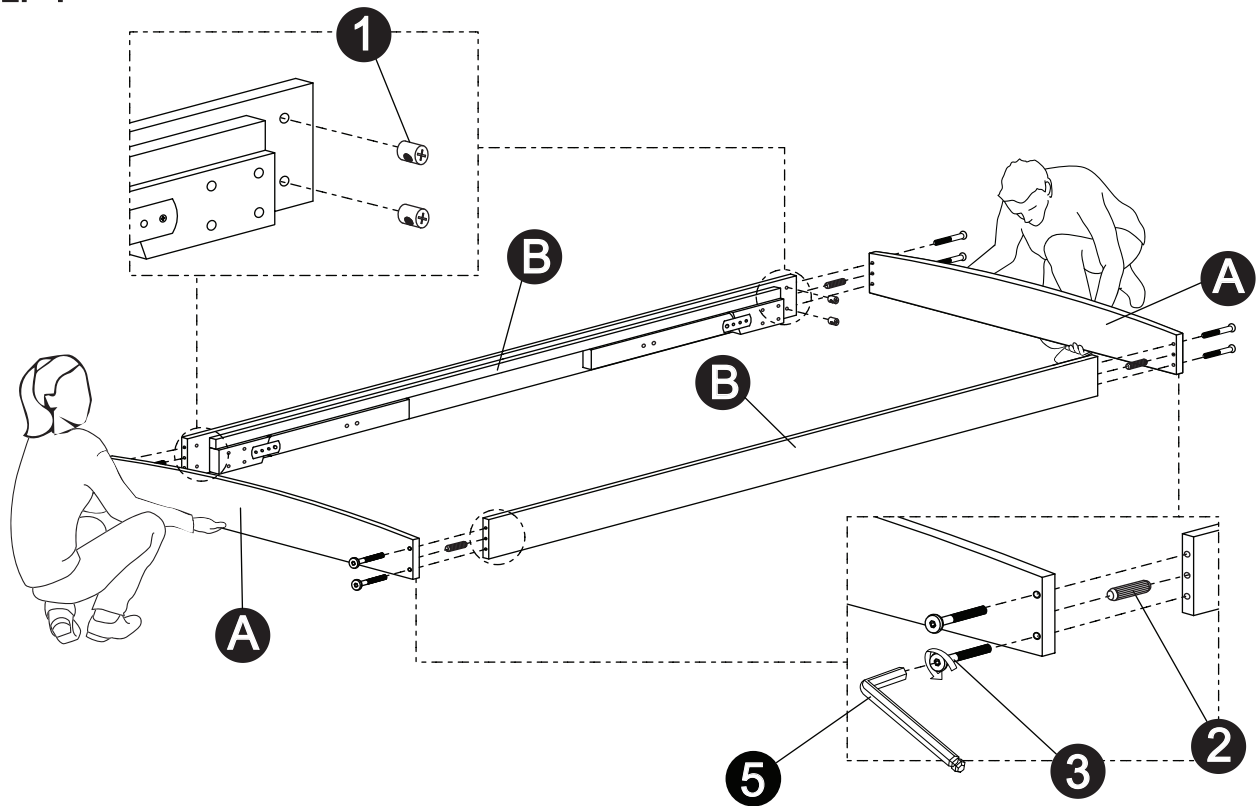

STEP 2

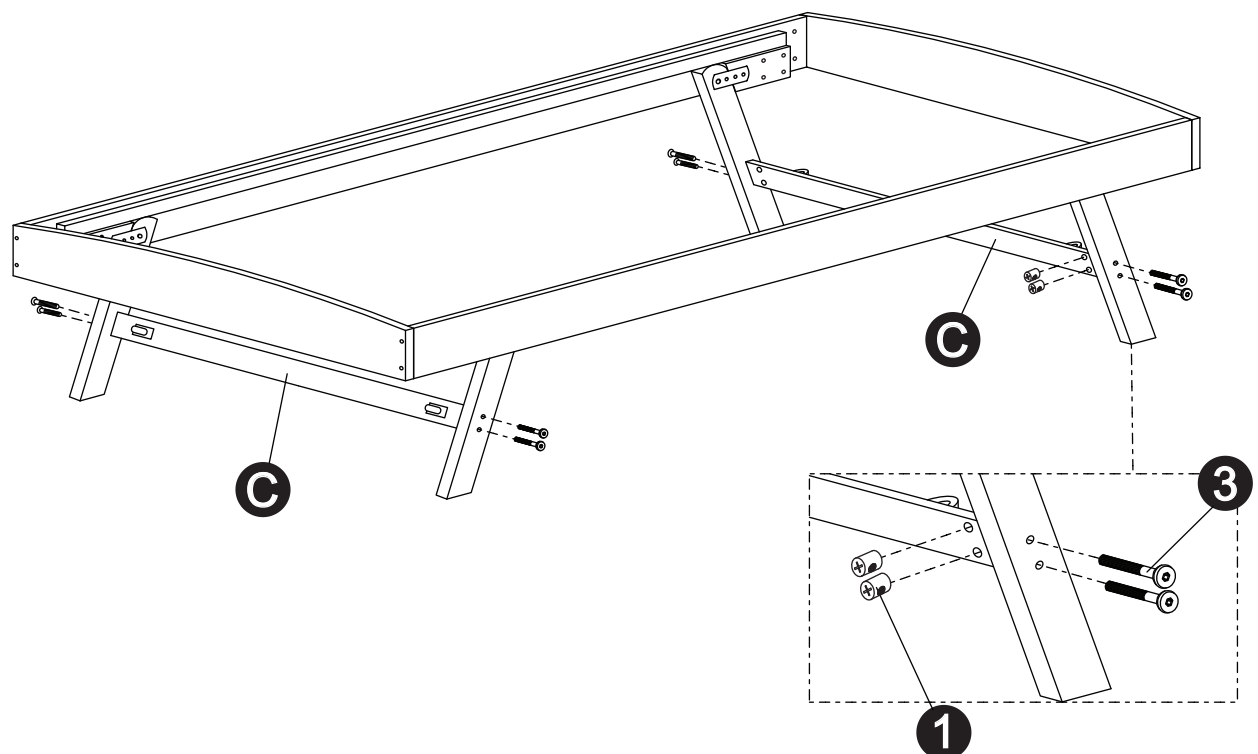

EZRA TRUNDLE

Made Exclusively for **Harvey Norman**

STEP 3

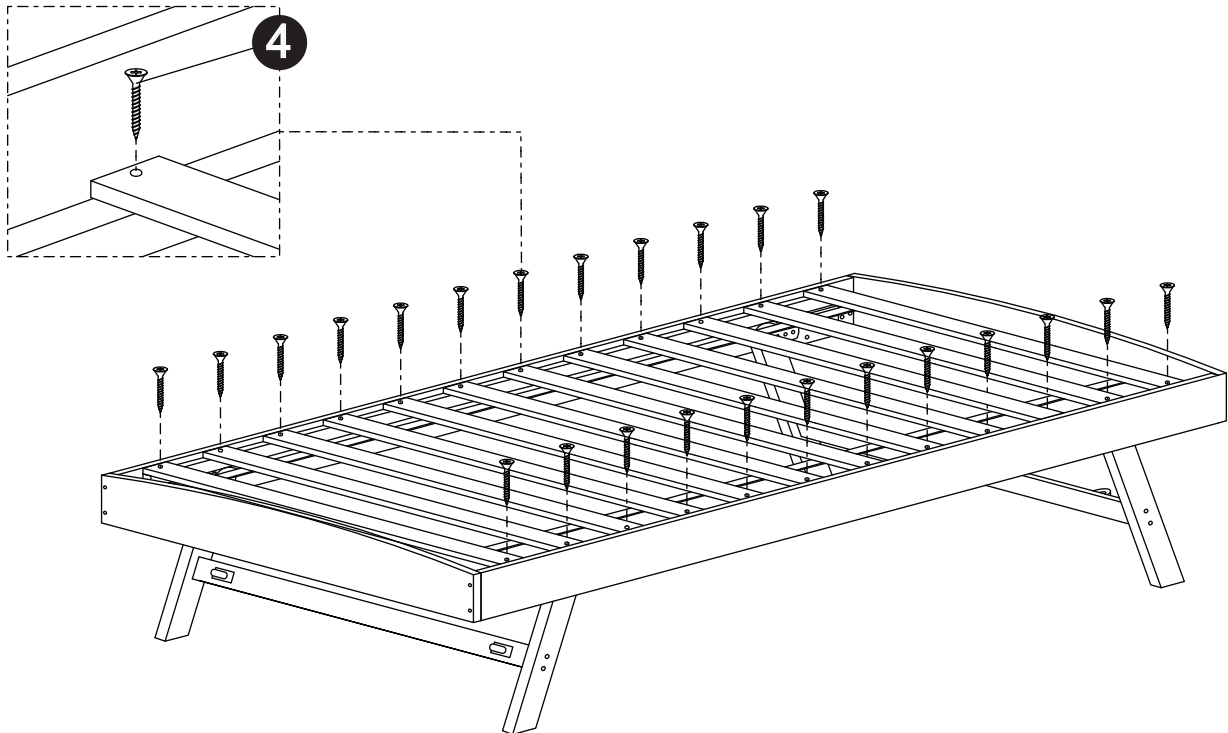

Complete Assembly

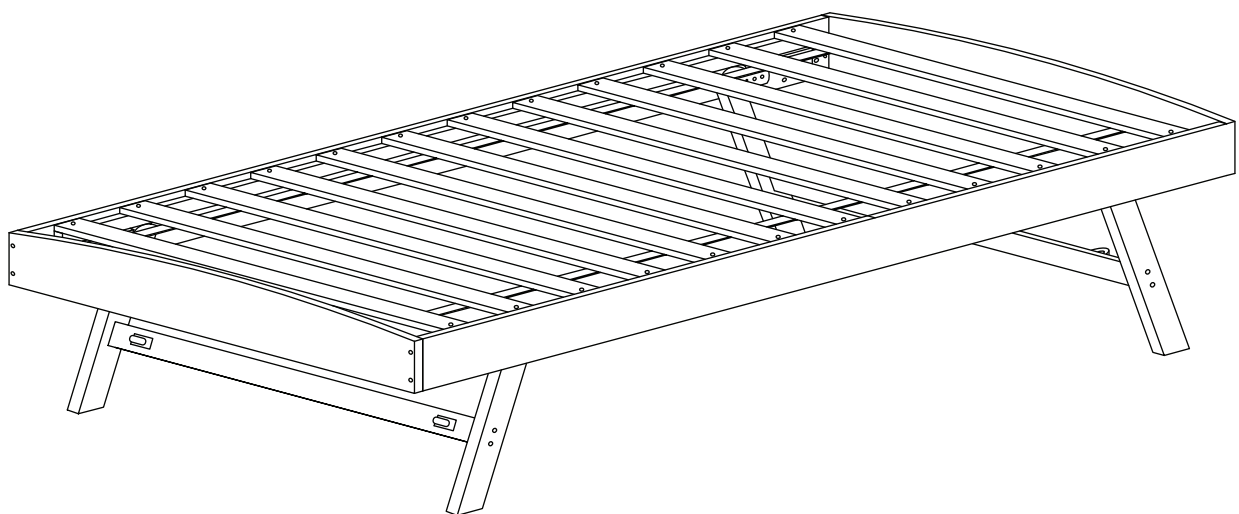

FINAL STEP

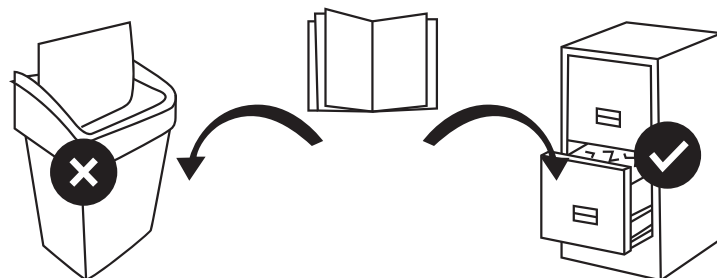
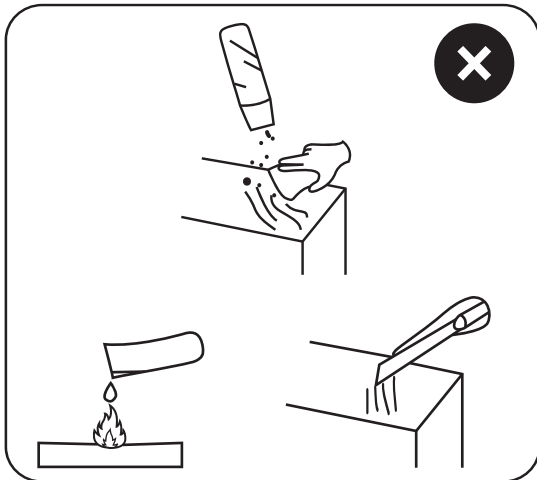

**FOR TIPS ON
HOW TO CARE FOR YOUR PIECE**

Please refer to our Care & Maintenance Guide in stores and online