

# HAMILTON 6 DRAWERS

---

*Made Exclusively for*

**Harvey Norman**<sup>®</sup>

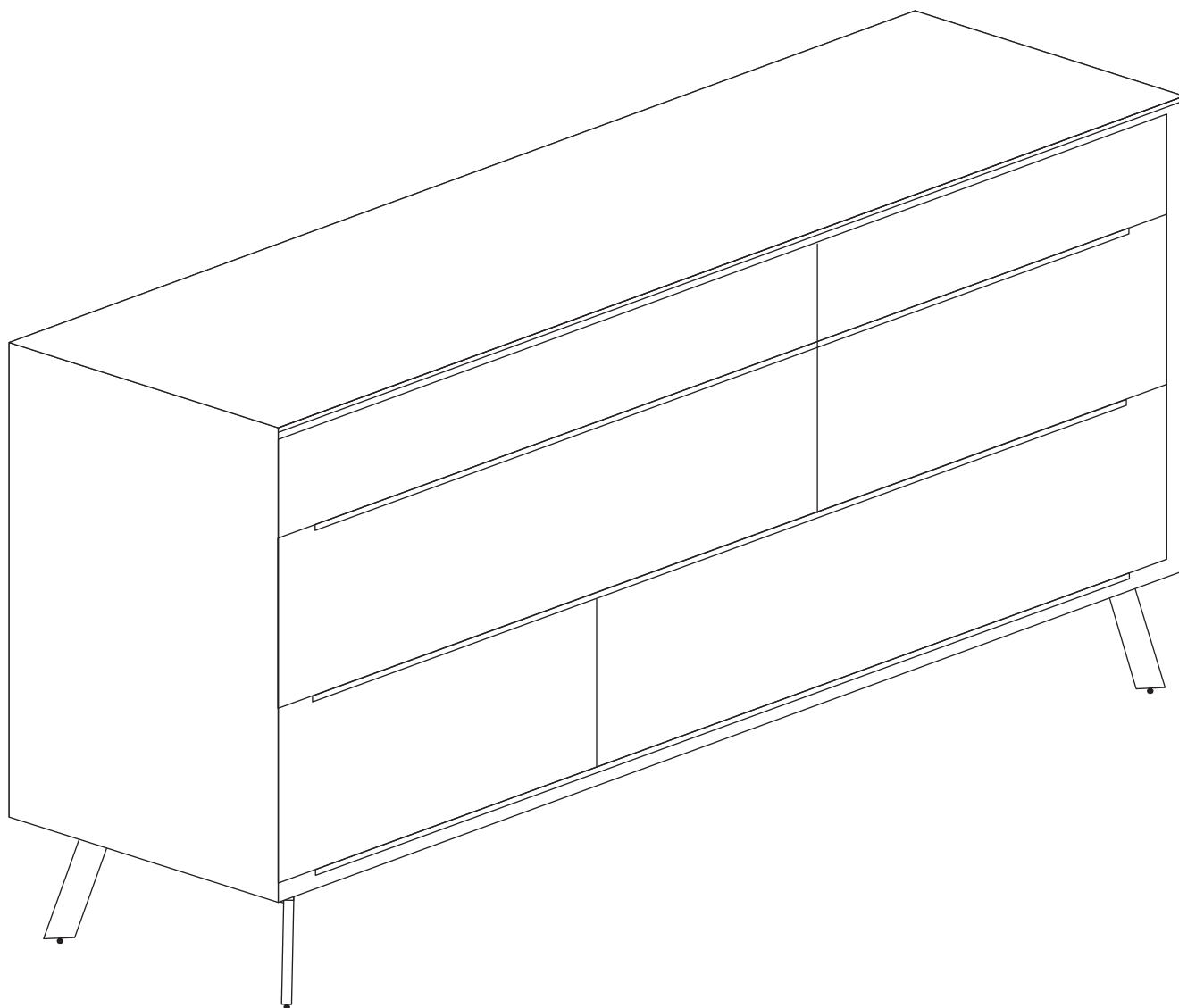

# ASSEMBLY MANUAL

MODEL: LV76.B62

# LIST OF AVAILABLE ASSEMBLY PARTS

**A**

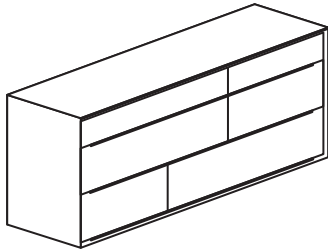

Cabinet  
x 01

**B**

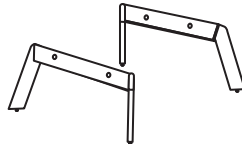

Leg Frame  
x 02

**1**

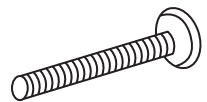

Bolts M8x55  
x 04

**2**



Flat Washers  
x 08

**3**



Spring Washers  
x 08

**4**



Nut M8x14  
x 04

**5**

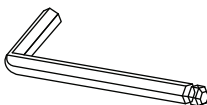

Allen Key K4  
x 01

**6**



Wrenches K14  
x 01

**7**

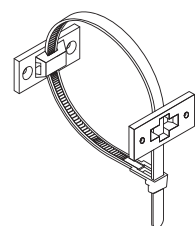

Anti-tip-kit  
x 02

**8**

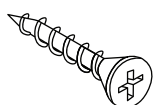

Screw M4x20  
x 04

**9**

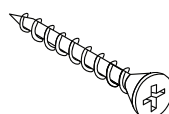

Screw M4x35  
x 04

**10**

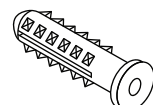

Wall plug  
x 04

## REQUIRED TOOLS

**30 MINUTES**



**TWO PEOPLE**



**SCREWDRIVER**

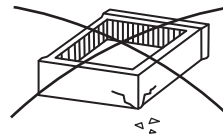
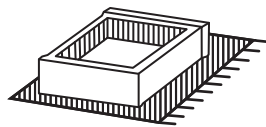
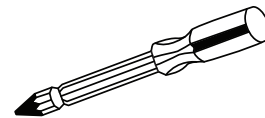

### ASSEMBLY TIPS

1. Remove hardware from box and sort by size.
2. Please check to see that all hardware and parts are present prior start of assembly.
3. Please follow attached instruction in the same sequence as numbered to assure fast and easy assembly



### WARNING!

- Do not FULLY-TIGHTEN the nut or bolt until all nut or nut bolt is ready to assembled.
- Do not OVER-TIGHTEN the nut or nut bolt to avoid causing damages to the thread.
- Keep all hardware part out of reach of children.

## STEP 1

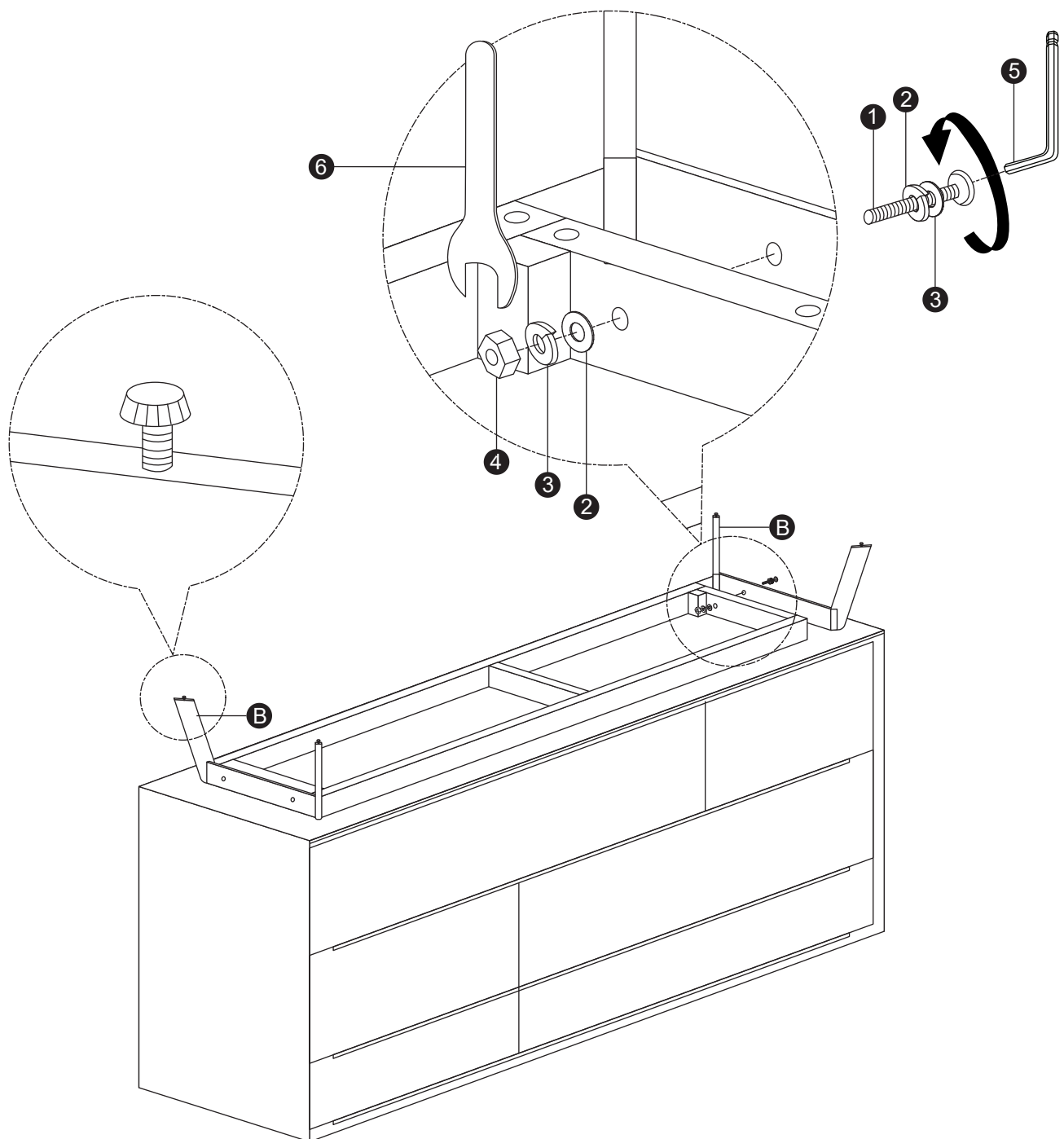

## FINAL STEP

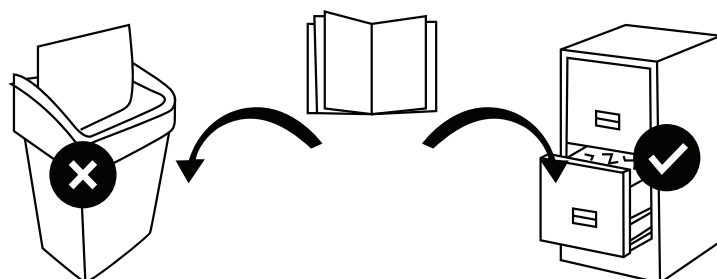
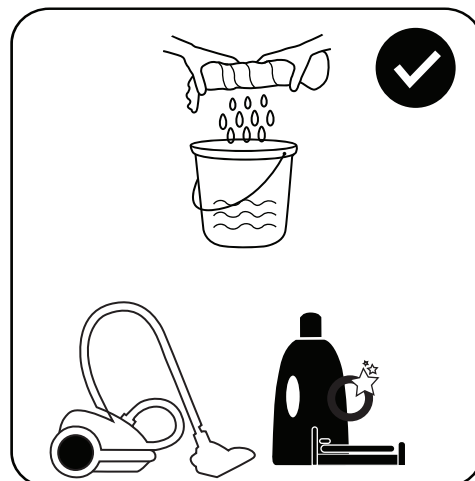
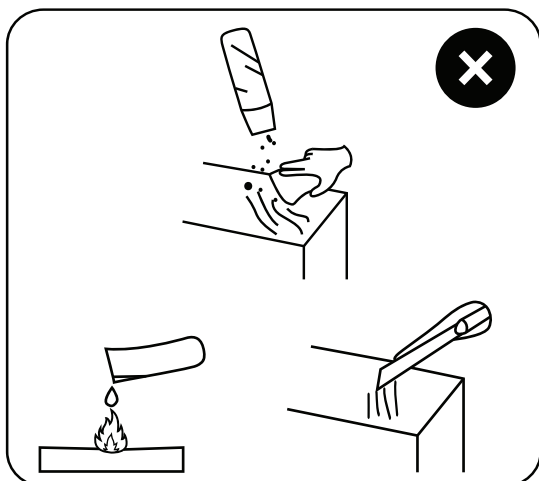

### FOR TIPS ON HOW TO CARE FOR YOUR PIECE

Please refer to our Care & Maintenance Guide in stores and online