

# KATHERINE DAY BED

---

*Made Exclusively for*  
**Harvey Norman**<sup>®</sup>

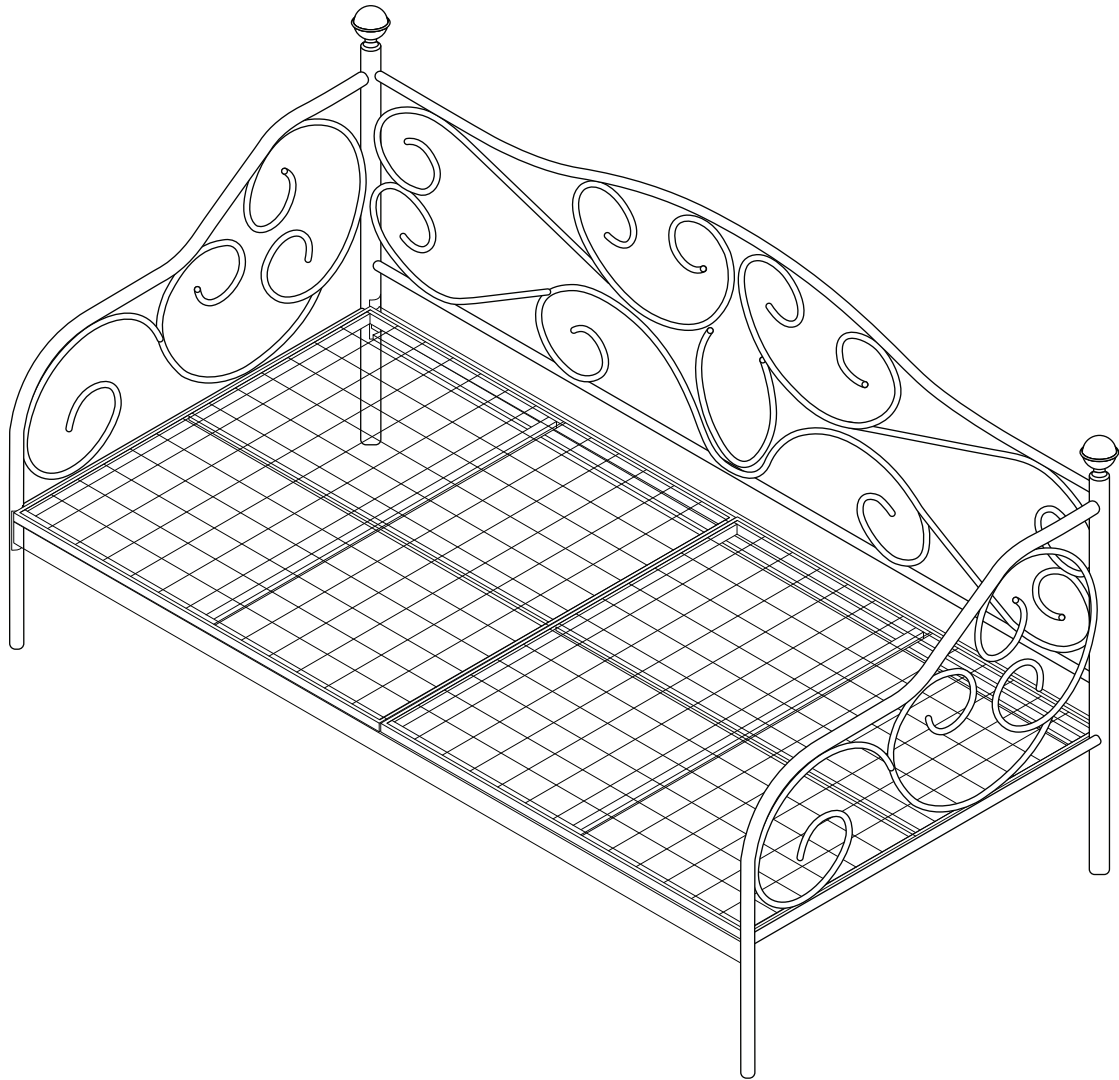

# ASSEMBLY MANUAL

MODEL: 14-B015/3DBWHT

# KATHERINE DAY BED

Made Exclusively for **Harvey Norman**

## LIST OF AVAILABLE ASSEMBLY PARTS

**A1**



Left footboard  
**x 01**

**A2**



Right footboard  
**x 01**

**B**

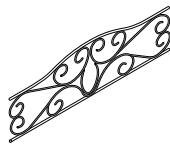

Headboard  
**x 01**

**C**

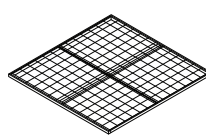

Slat  
**x 02**

**D**



Side Rail  
**x 02**

**E**



bed knob  
**x 04**

**F**



Foot cap  
**x 02**

**1**



6mm X 22mm  
**x 12**

**2**



6mm X 50mm  
**x 04**

**3**

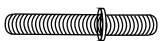

6mm X 38mm  
**x 02**

**4**

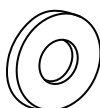

Flat Washer  
**x 12**

**5**



Curved washer  
**x 04**

**6**

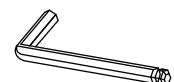

Allen Key  
**x 01**

# KATHERINE DAY BED

Made Exclusively for **Harvey Norman**

## REQUIRED TOOLS

30 MINUTES



TWO PEOPLE

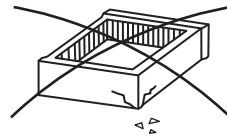
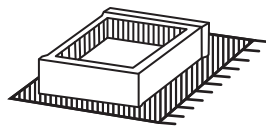

### ASSEMBLY TIPS

1. Remove hardware from box and sort by size.
2. Please check to see that all hardware and parts are present prior of assembly.
3. Please follow attached instruction in the same sequence as numbered to ensure fast and easy assembly.



### WARNING!

- Do not tighten the nuts or bolts until all nuts and bolts are in place and ready to be tightened
- Do not over tighten the nuts or bolts as this will cause damage to the thread
- Keep all parts out of the reach of children

# KATHERINE DAY BED

Made Exclusively for **Harvey Norman**

## STEP 1

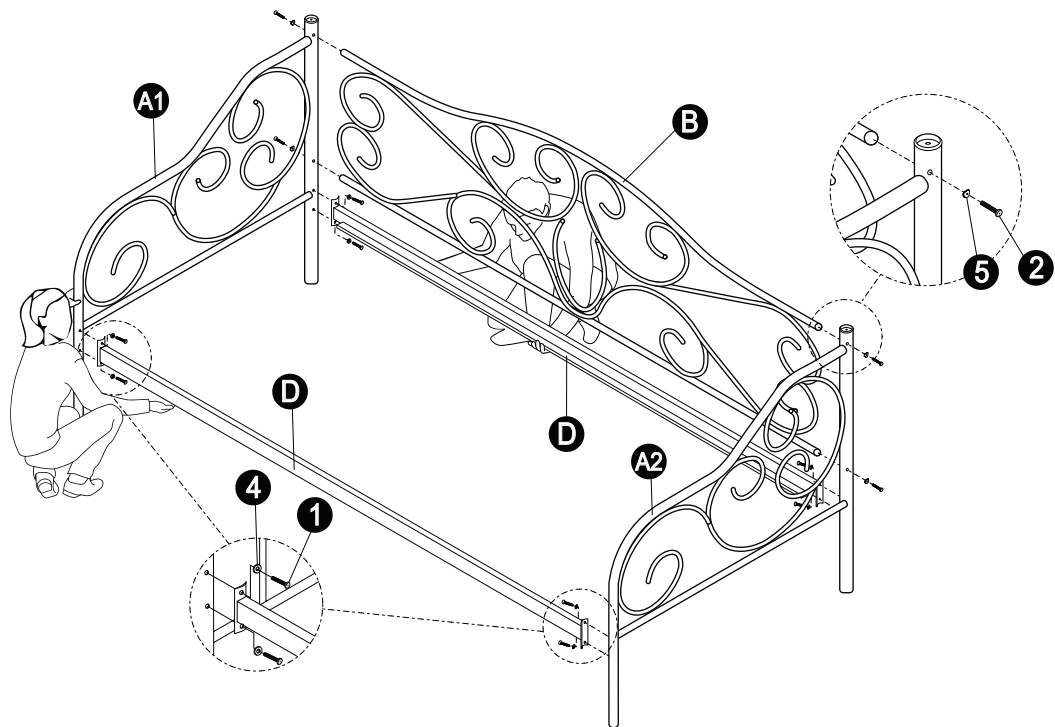

## STEP 2

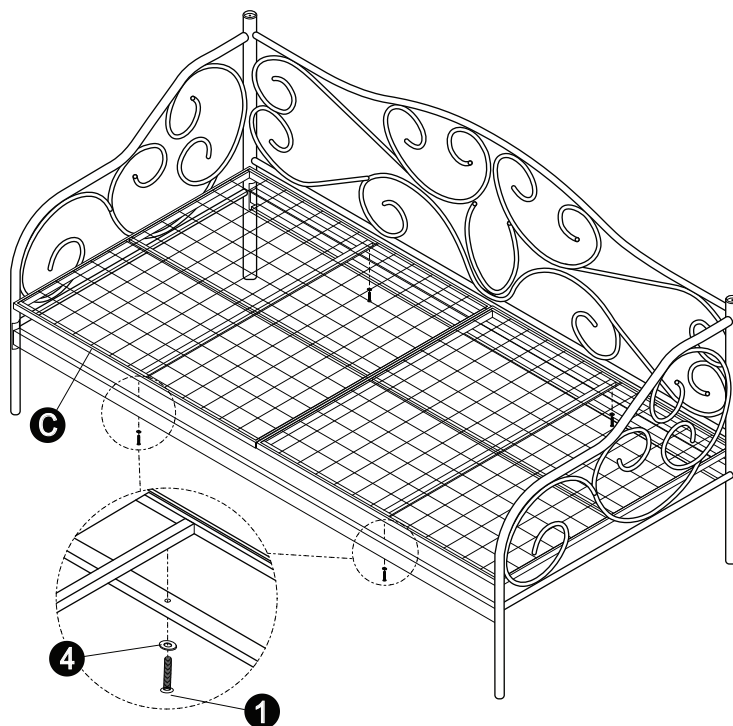

# KATHERINE DAY BED

Made Exclusively for **Harvey Norman**

## STEP 3

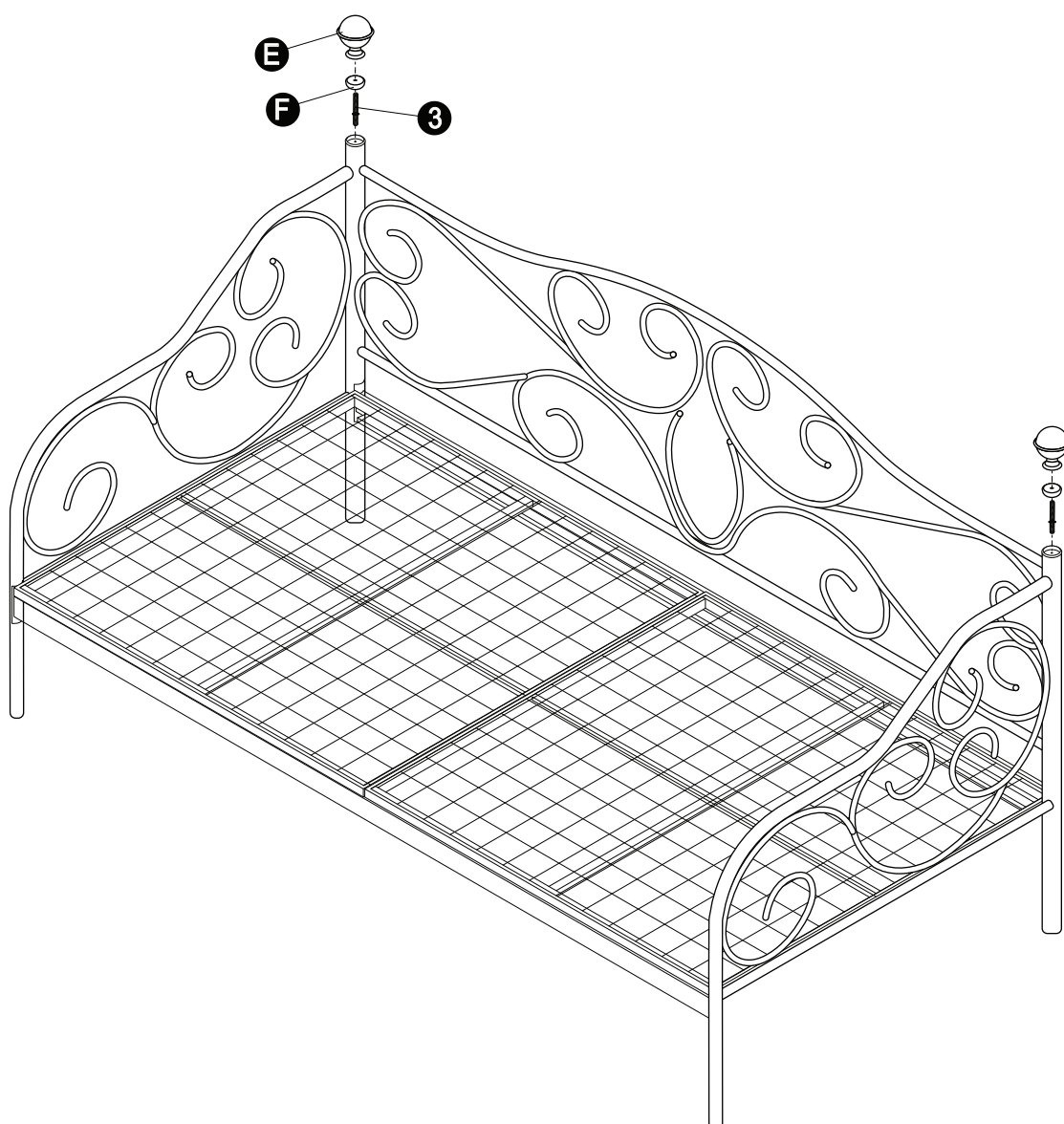

# KATHERINE DAY BED

Made Exclusively for **Harvey Norman**

## FINAL STEP

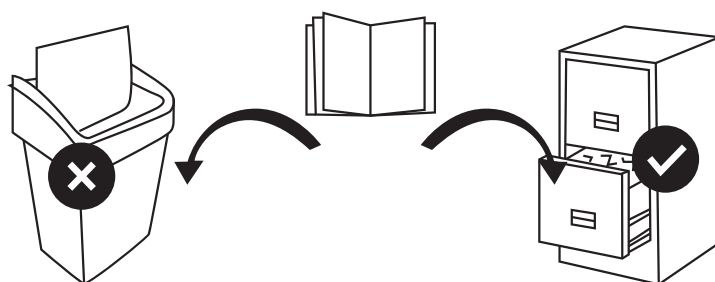
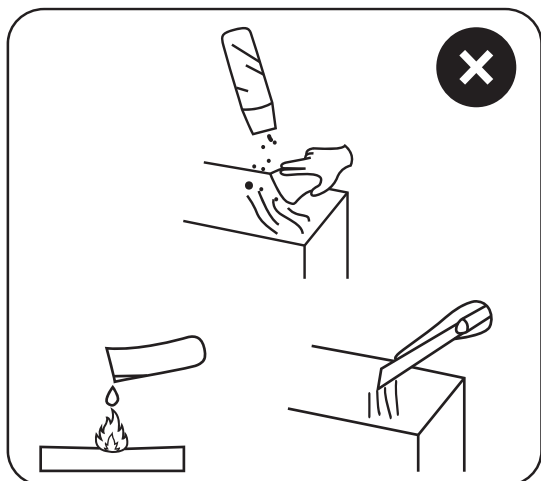

### FOR TIPS ON HOW TO CARE FOR YOUR PIECE

Please refer to our Care & Maintenance Guide in stores and online