

LEWIS 4FT6

Made Exclusively for

Harvey Norman[®]

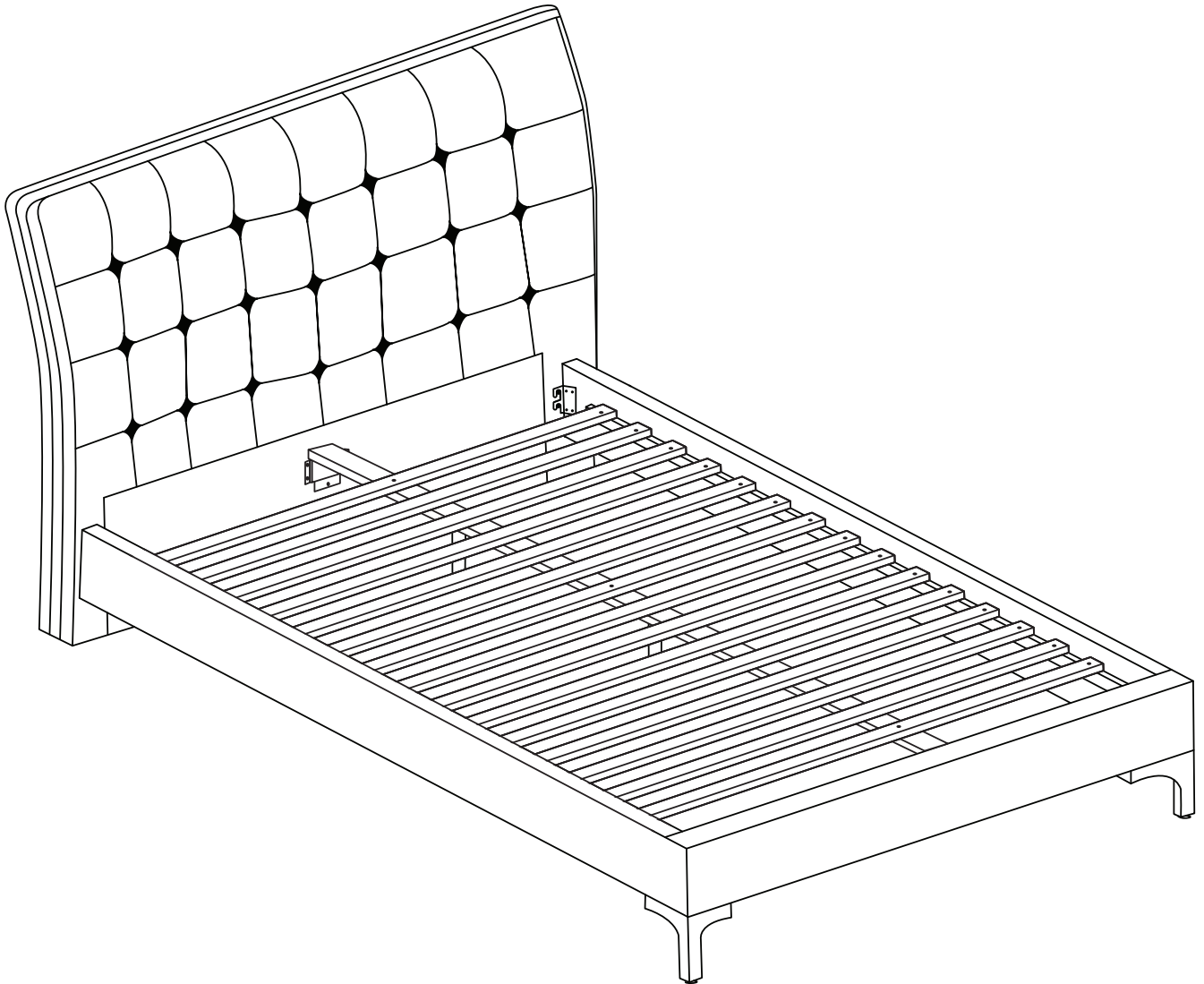

ASSEMBLY MANUAL

MODEL: CF 9325 (4'6")

LIST OF AVAILABLE ASSEMBLY PARTS

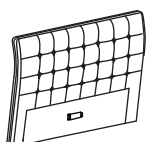
A

Head Board
x 01

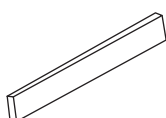
B

Foot Board
x 01

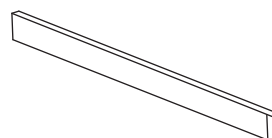
C

Side Rail
x 02

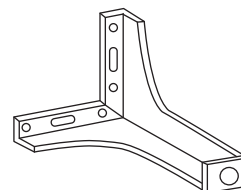
D

Legs 135 (H)
x 02

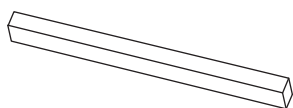
E

Center Rail 1930mm
x 01

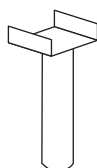
F

Support Leg 215mm
x 02

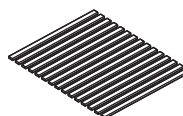
G

15 pcs Slat 1397mm
x 01

1

JCBC M6 X 40
x 05

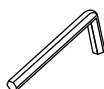
2

M5 x 70mm
x 01

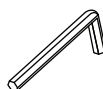
3

M4 x 65mm
x 01

4

CSK M4 x 25mm
x 08

5

CSK M4 x 32mm
x 08

6

Flat washers
x 06

7

Spring washers Ø8
x 16

8

JCBB M8 X 20
x 08

REQUIRED TOOLS

30 MINUTES

TWO PEOPLE

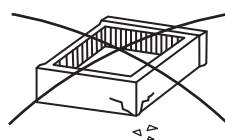
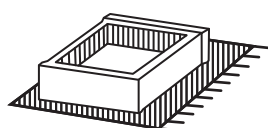
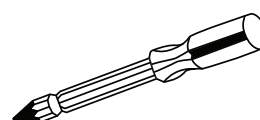
SCREWDRIVER

ASSEMBLY TIPS

1. Remove hardware from box and sort by size.
2. Please check to see that all hardware and parts are present prior to assembly.
3. Please follow attached instruction in the same sequence as numbered to ensure fast and easy assembly.



WARNING !

Before Getting Started

- Read the instructions carefully prior to assembling the product.
- Carefully remove all packaging materials and retain for future use.
- Choose a clean level, spacious assembly area.
- Avoid hard surfaces that may damage the product.
- Ensure that you have all required contents for complete assembly.
- Take care when Assemble the product in close proximity to where you intend to position the Item.
- Do not over tighten the screws and bolts and be careful using power tools as they may damage the threads.
- When you have finished assembling the product, place it on a flat surface and make sure it is stable before use.
- Please do not completely tighten bolts and/or screws until assembly is finished.

Cleaning & Maintenance

- Keep the product away from direct heat and sunlight.
- Prolonged exposure to heat sources may cause glazing, melting and scorching, or even cause color to fade.
- Regular vacuuming or light brushing helps to remove dirt and prevent soil build-up, which increases the appearance wear.
- Periodically (every 90 days) make sure that the screws are fully tightened.

STEP 1

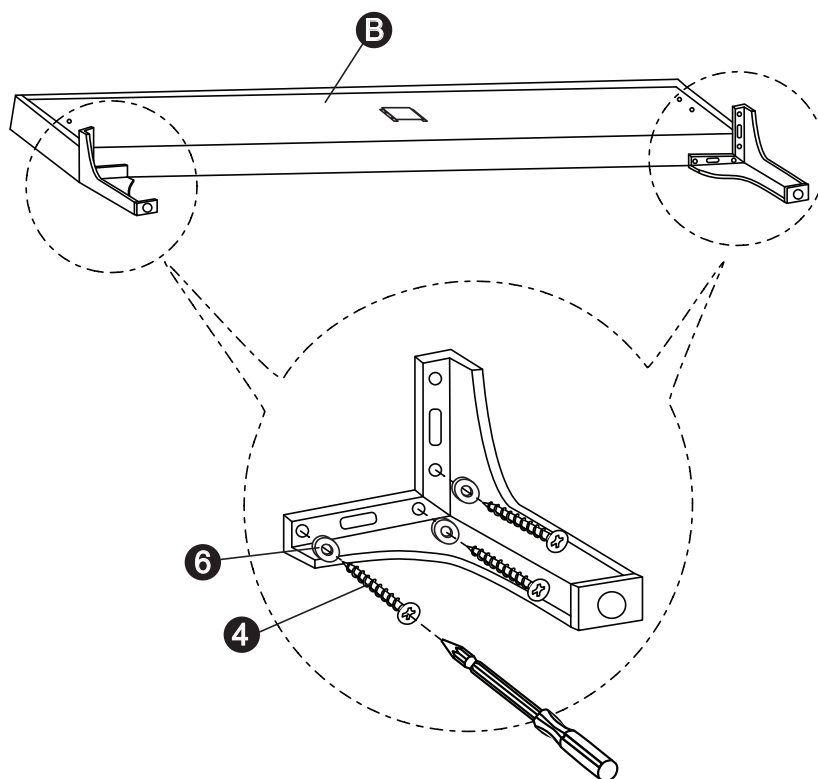

STEP 2

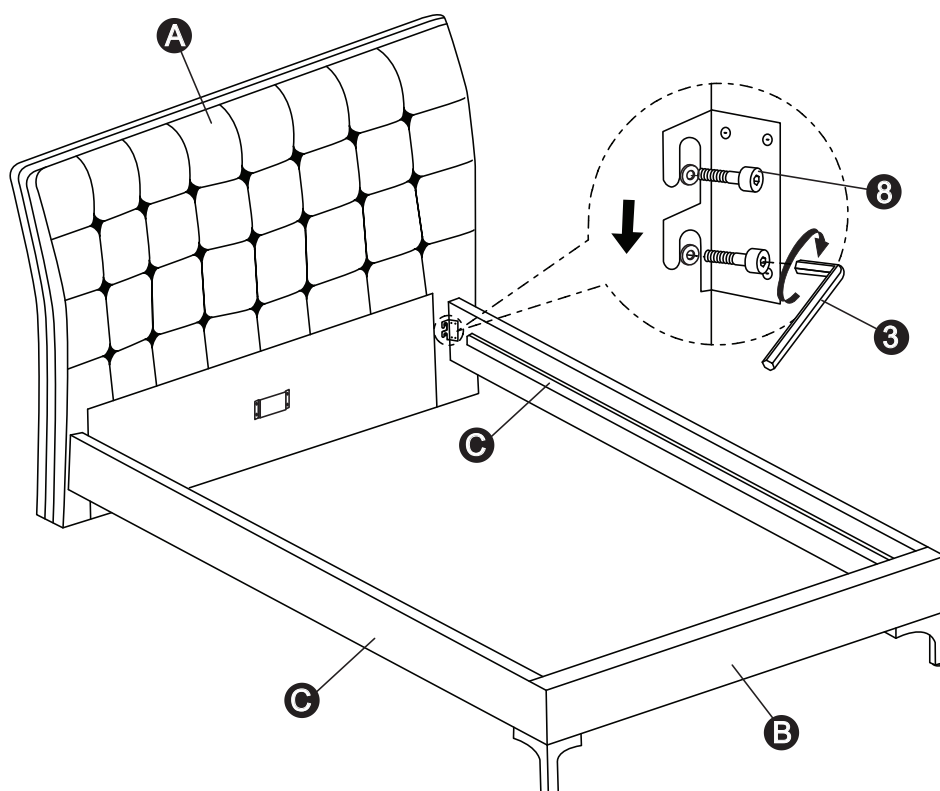

STEP 3

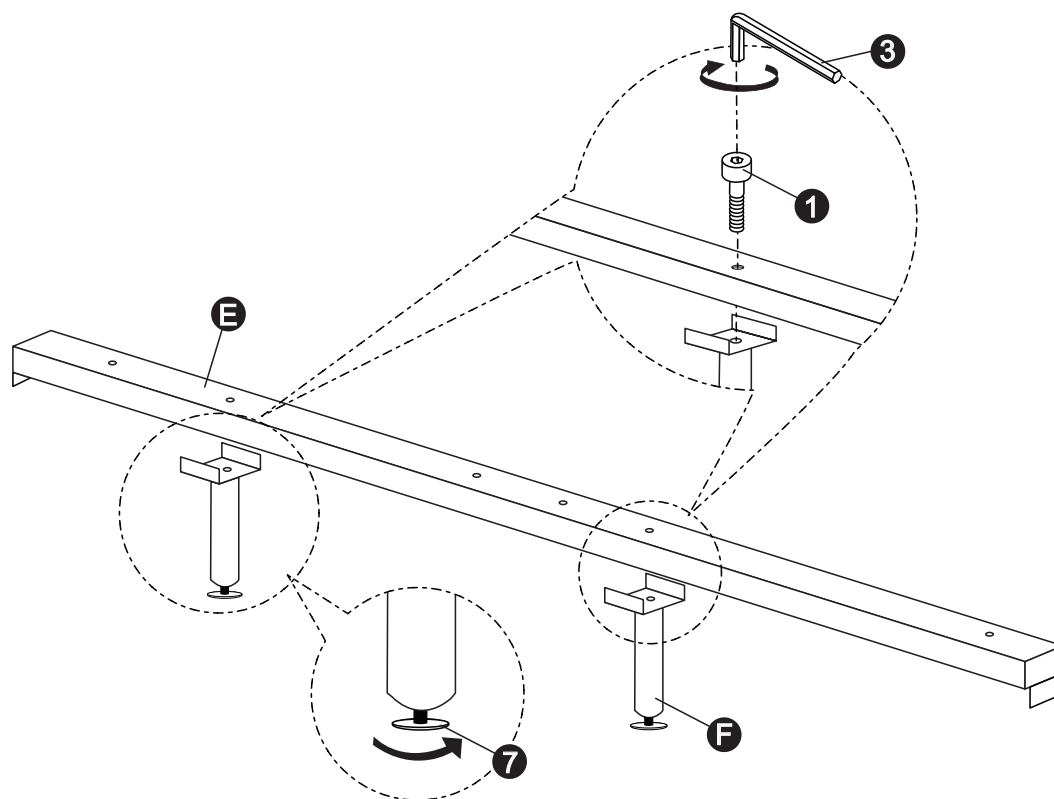

STEP 4

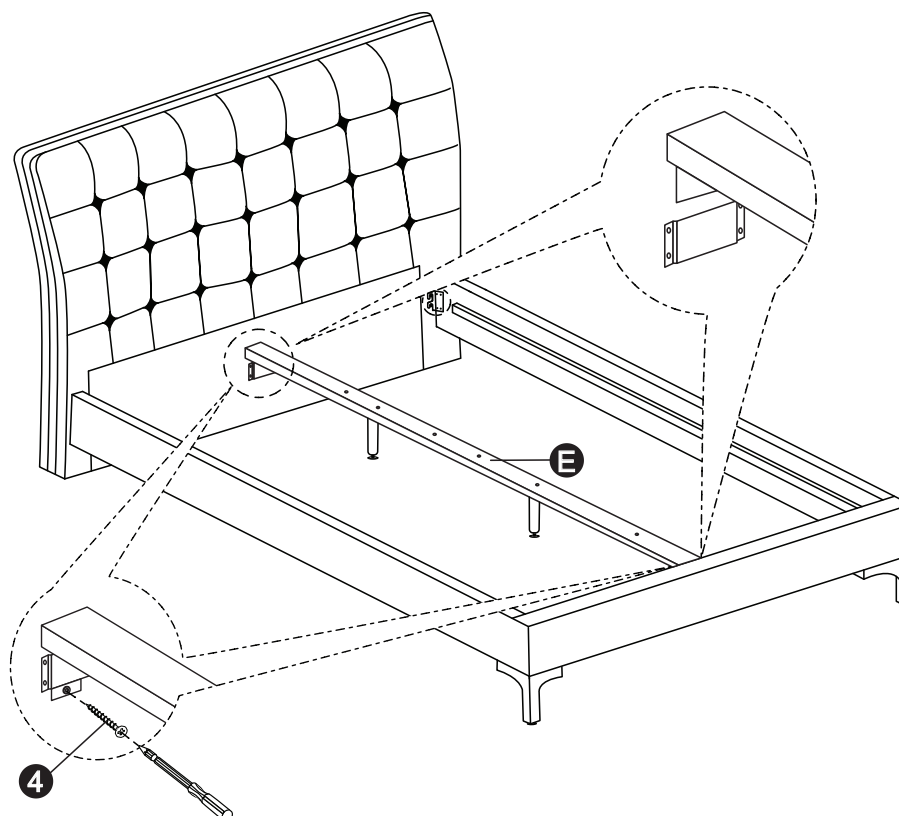

Made Exclusively for **Harvey Norman®**

STEP 5

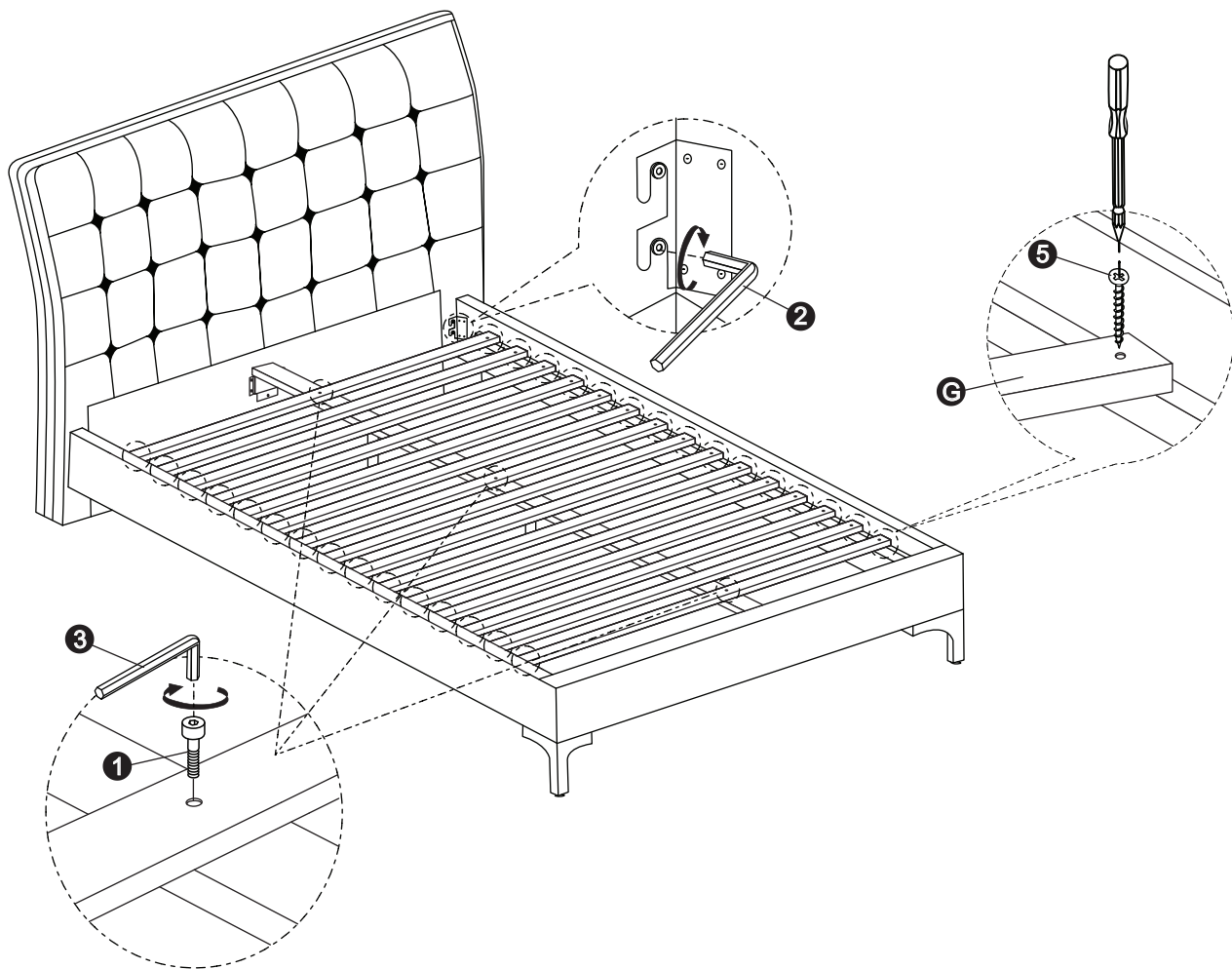

FINAL STEP

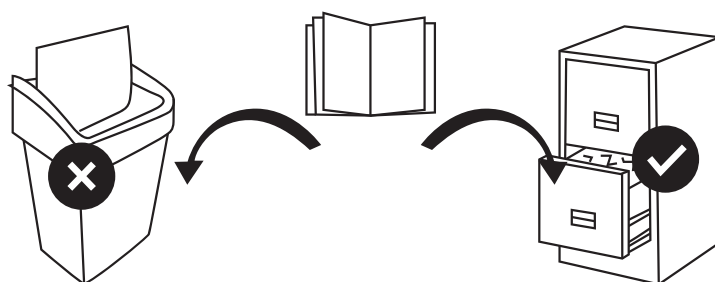
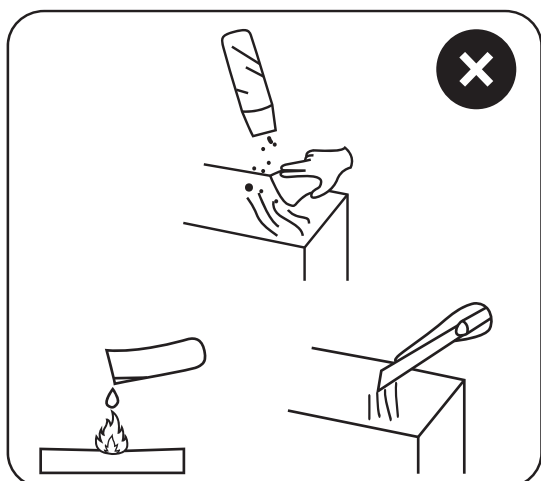

FOR TIPS ON HOW TO CARE FOR YOUR PIECE

Please refer to our Care & Maintenance Guide in stores and online