

WALLACE

Made Exclusively for

Harvey Norman®

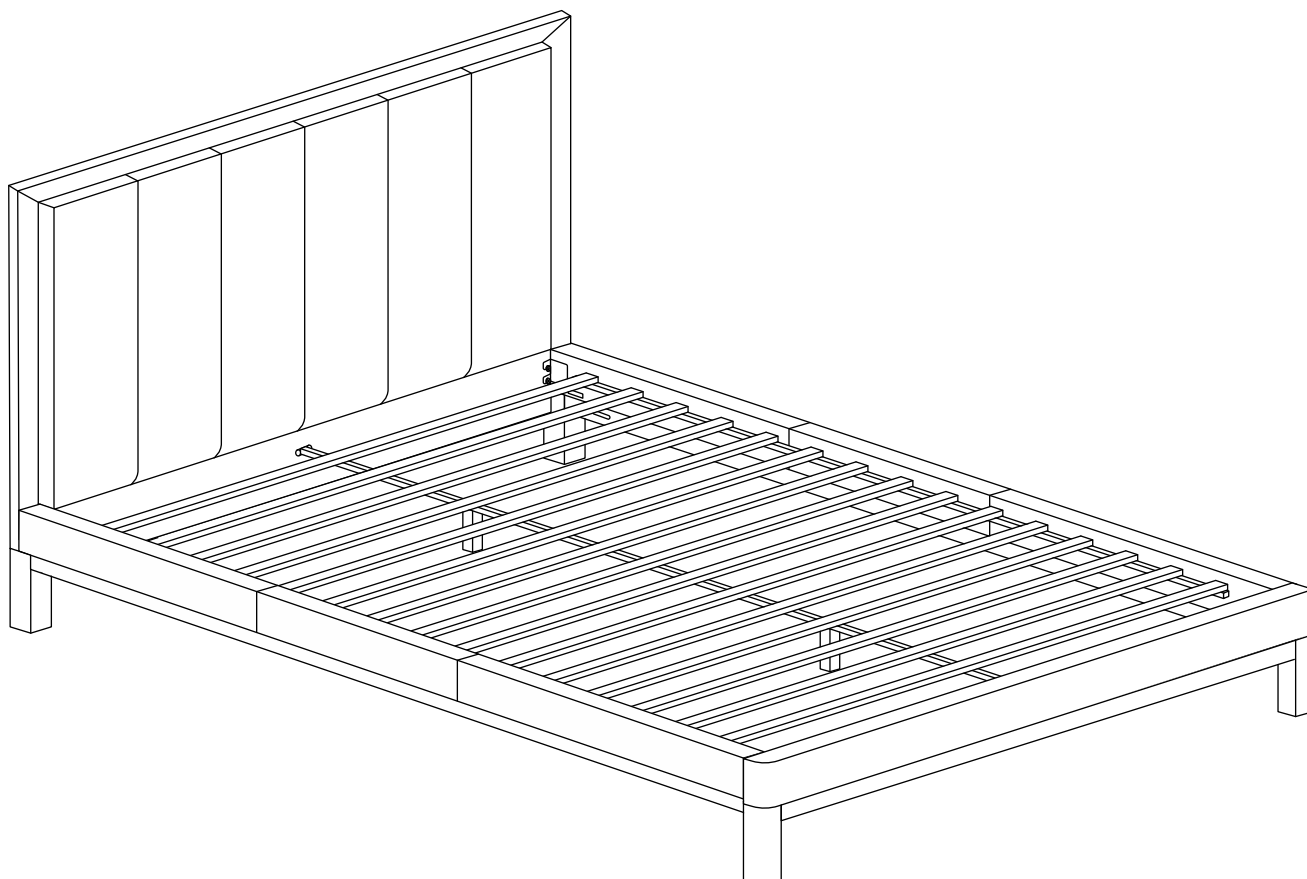

ASSEMBLY MANUAL

MODEL: WALLACE 4FT6 BED

**LIST OF AVAILABLE
 ASSEMBLY
 PARTS**

1

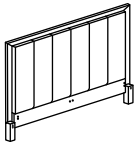

Head Board
x 01

2



Foot Board
x 01

3



Said Rail
x 02

4



Said Rail Wooden Bar
x 02

5



Foot Board Wooden Bar
x 01

6



Center Rail
x 01

7

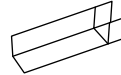

Support Leg
x 02

8



Slat
x 15

9

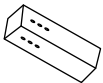

Head Board Bed Leg
x 02

10

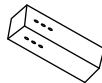

Foot Board Bed Leg
x 02

A

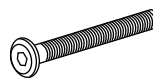

JCBB M8 X 40MM
x 08

B

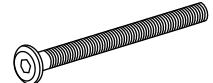

JCBC M6 X 60MM
x 17

C

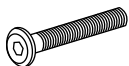

JCBC
 M6 X 50MM
x 10

D



JCBC
 M6 X 30MM
x 04

E



Spring Washer
 5/16"
x 39

F



Flat Washer
 5/16"
x 10

G



Flat Washer
 1/4"
x 10

H

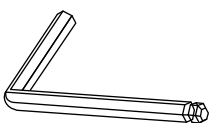

Allen Key With Ball M4
x 01

I



Allen Key M5
x 01

J

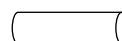

Plastic Dowel M8 X30
x 04

K



CSK M4 X 30MM
x 24

REQUIRED TOOLS

30 MINUTES



TWO PEOPLE



SCREWDRIVER

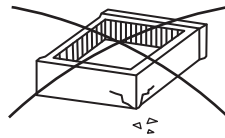
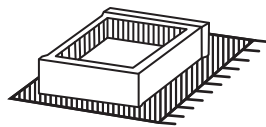
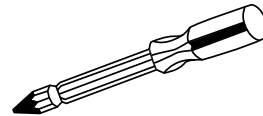

ASSEMBLY TIPS

1. Please check the packing contents before assembling this product to ensure that all parts are included
2. This product takes about thirty minutes for two people to assemble
3. Please read Assembly Instructions completely before assembling the product
4. You will need a Phillips screwdriver to complete the assembly



WARNING!

- Do not FULLY-TIGHTEN the nut or bolt until all nut or nut bolt is ready to be assembled.
- Do not OVER-TIGHTEN the nut or nut bolt to avoid causing damage to the thread.
- Keep all hardware parts out of reach of children.

STEP 1

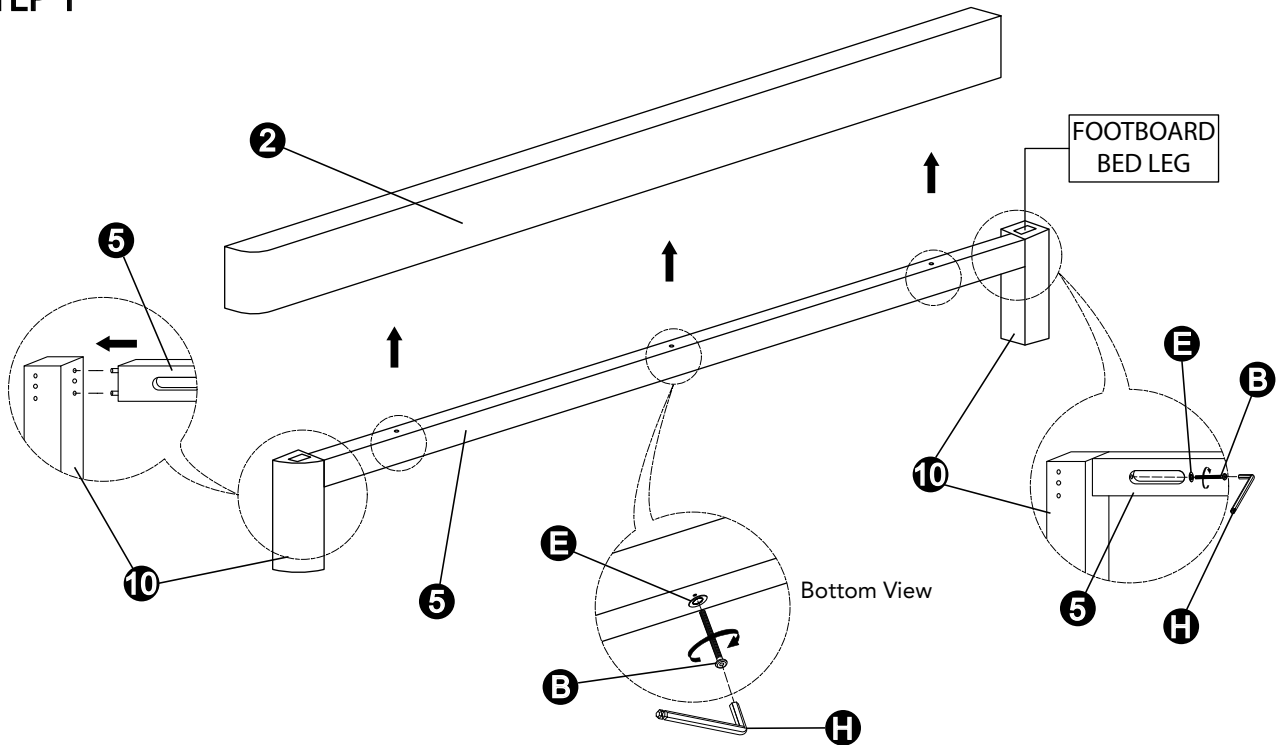

STEP 2

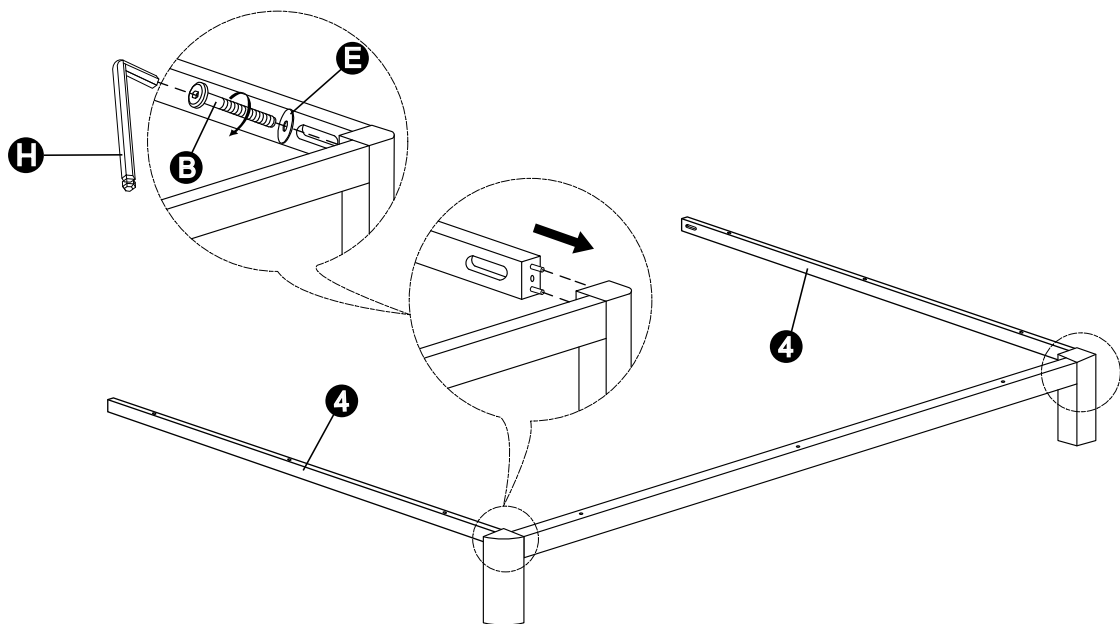

STEP 3

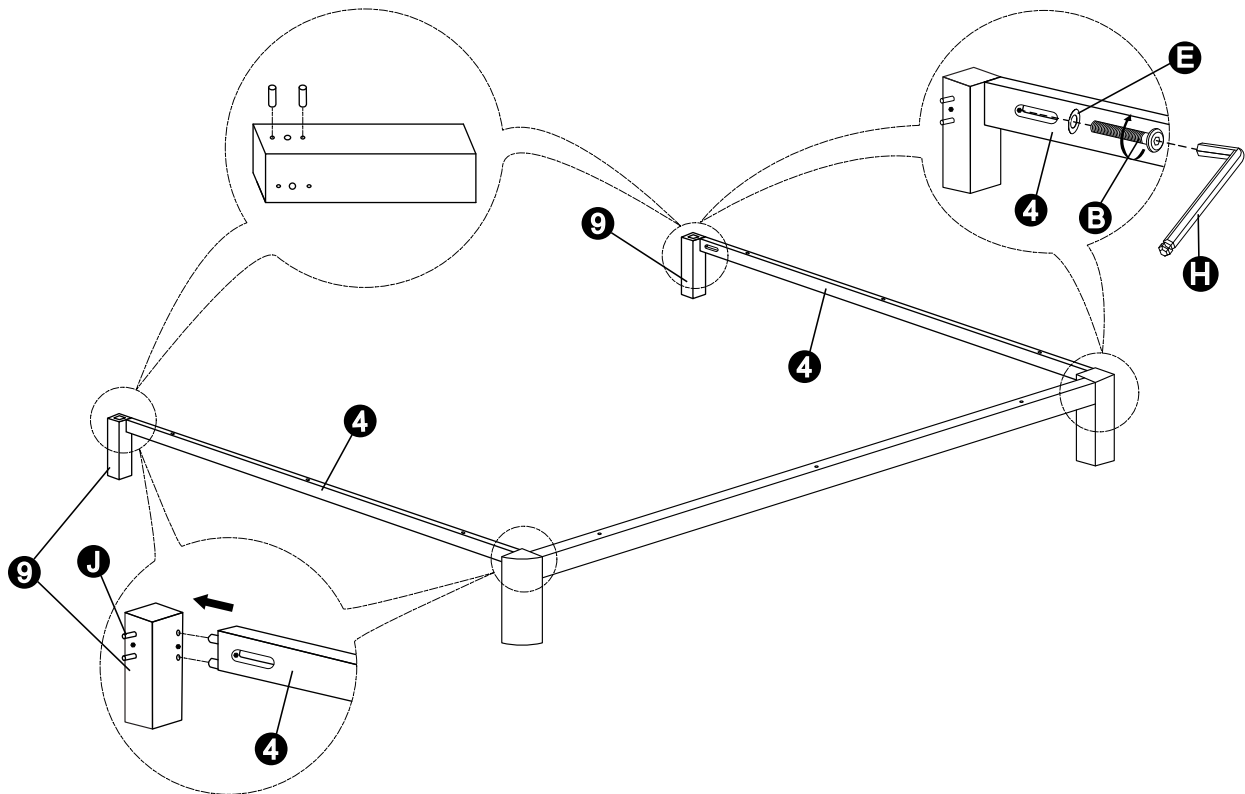

STEP 4

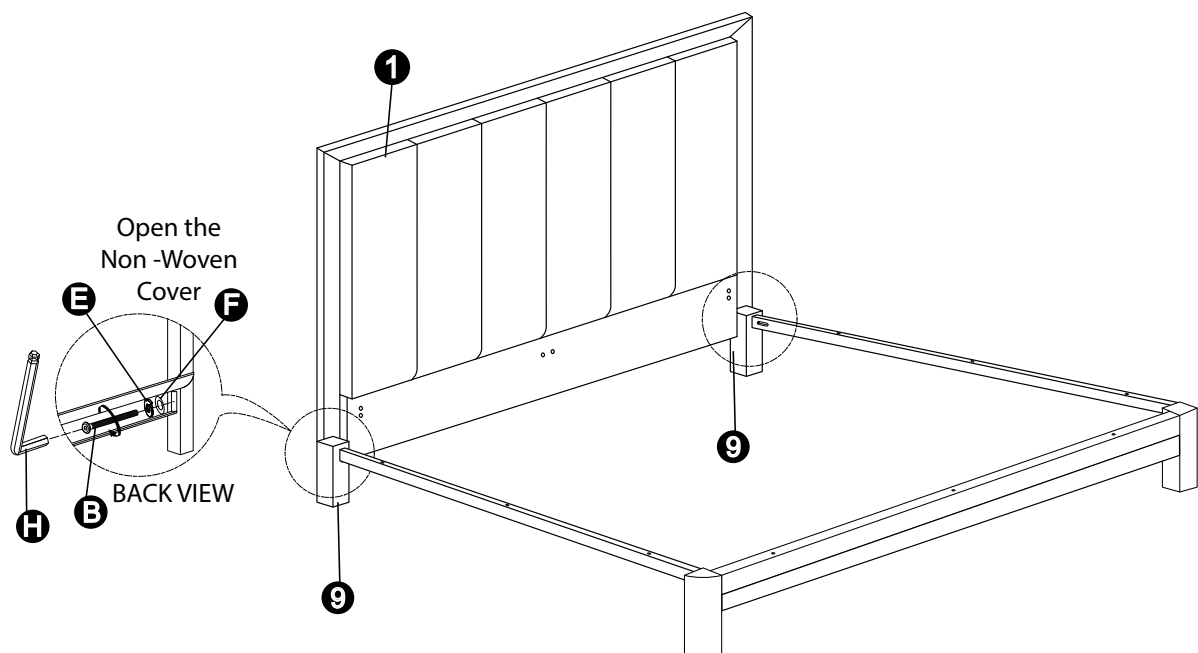

STEP 5

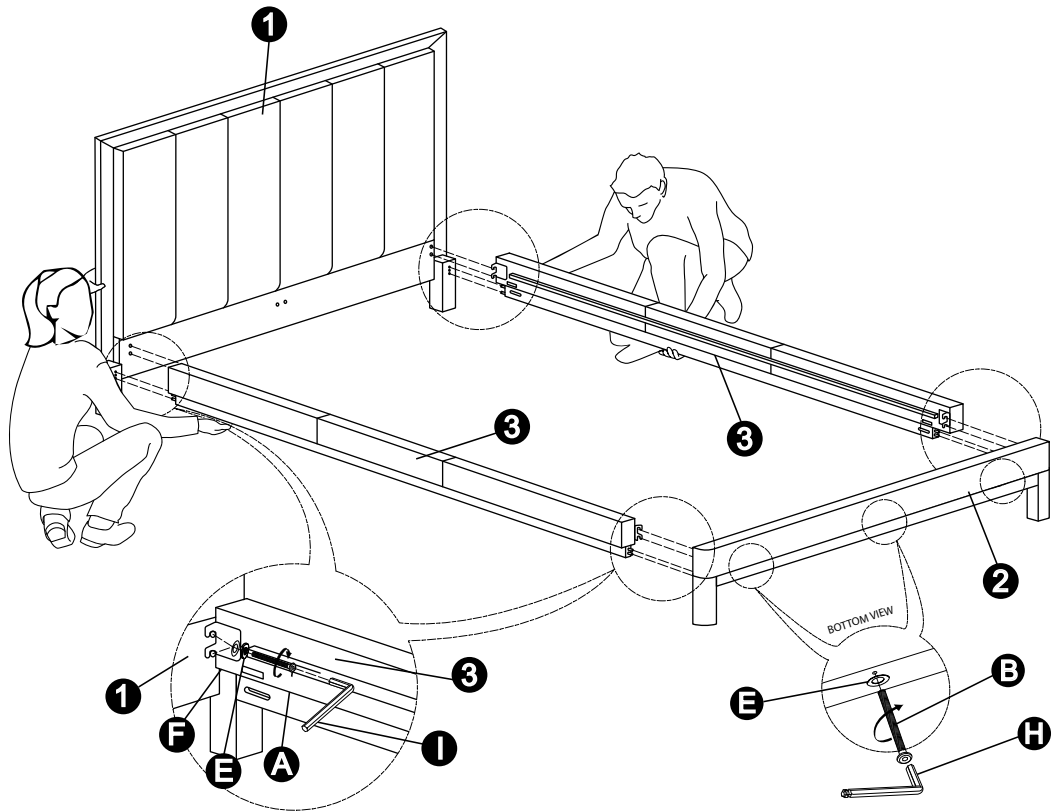

STEP 6

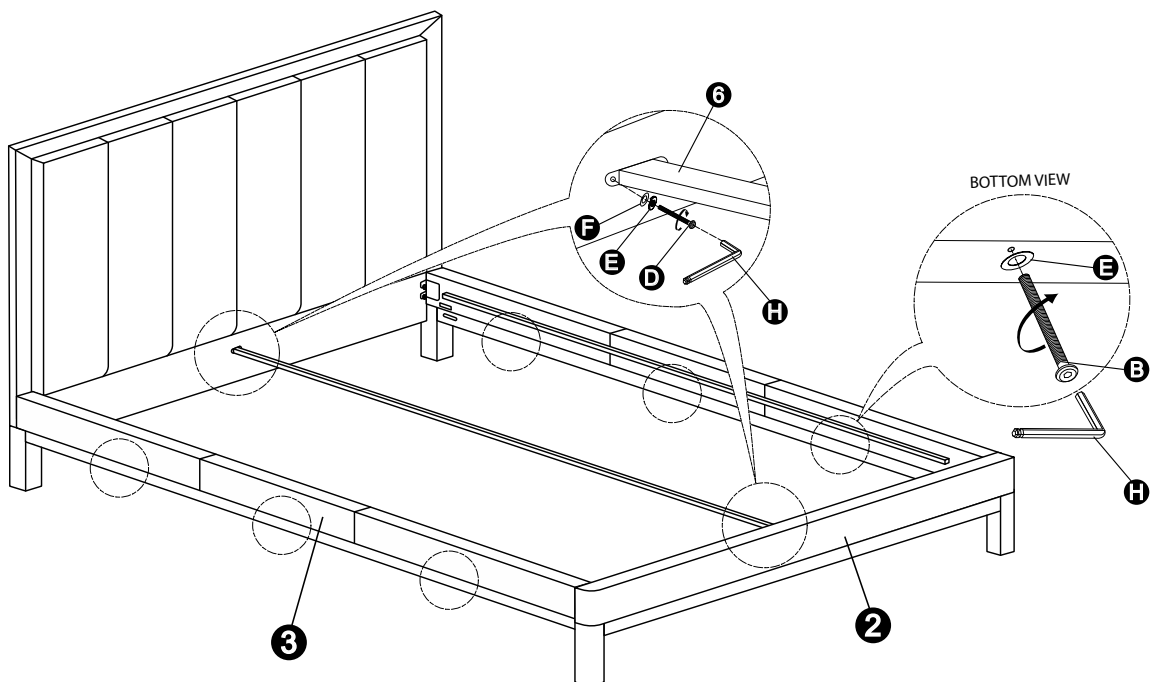

STEP 7

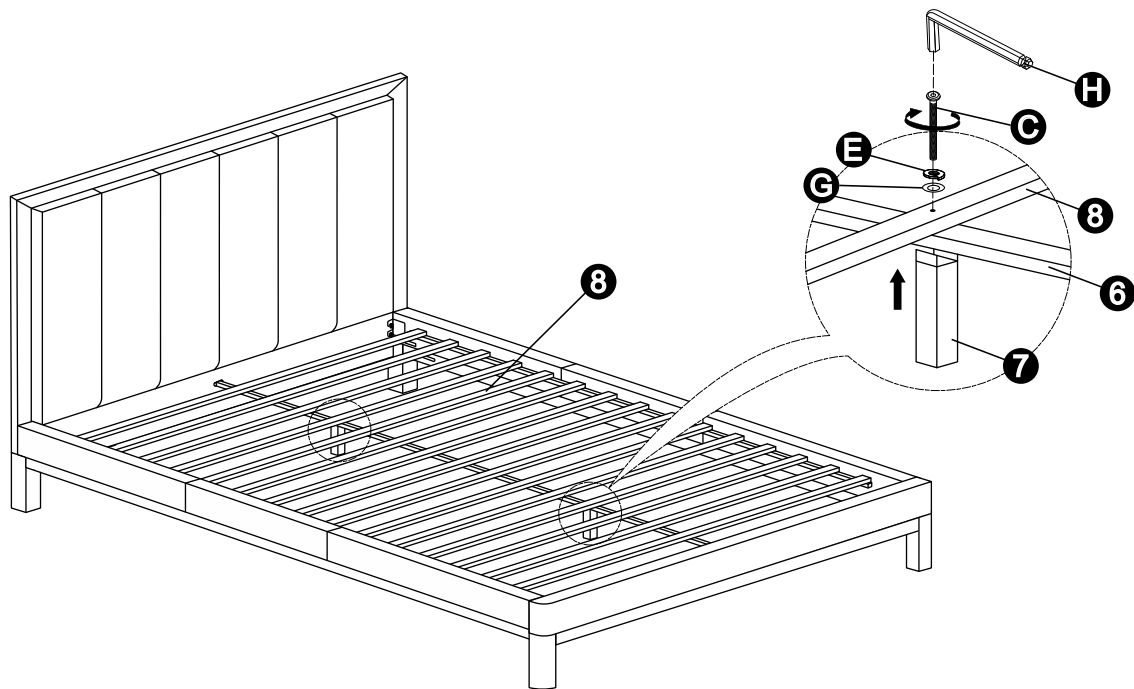

STEP 8

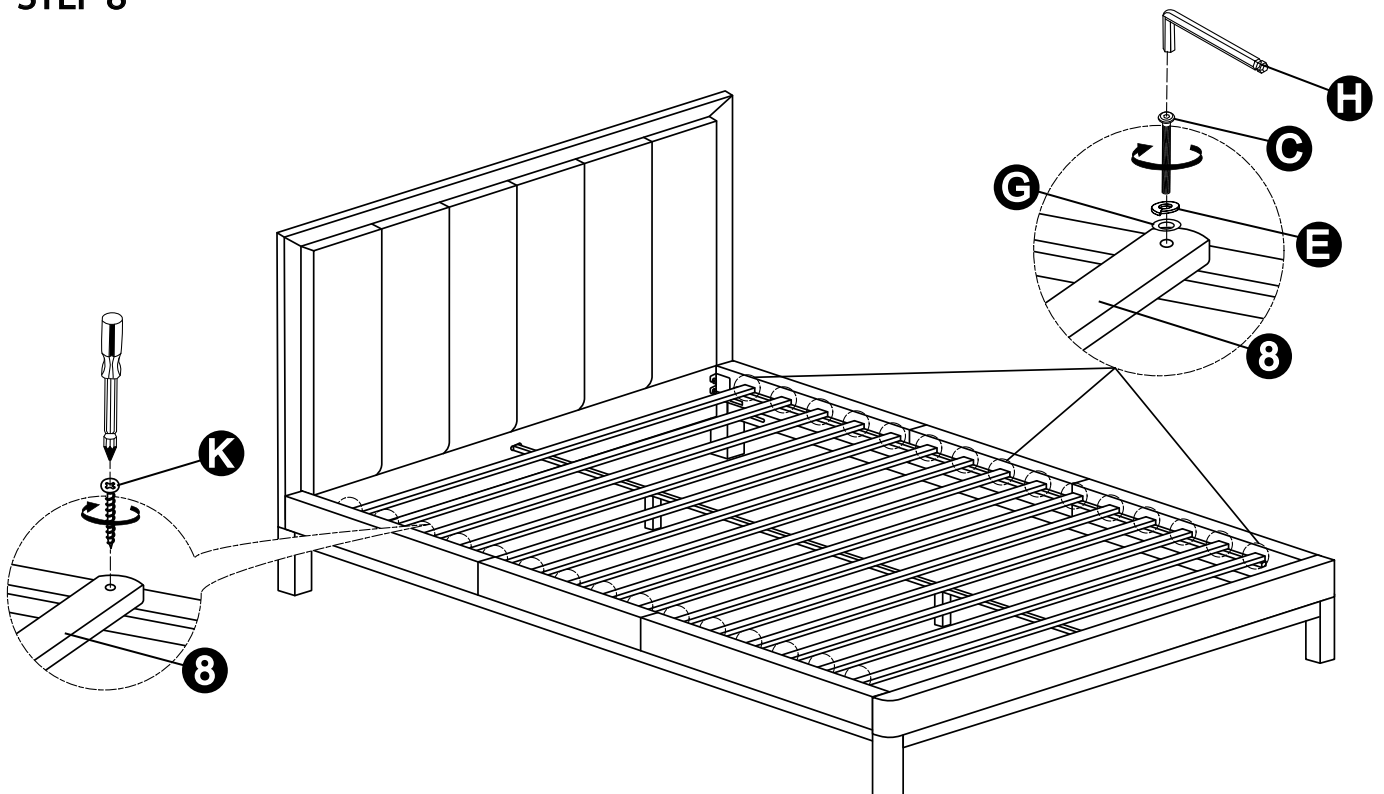

FINAL STEP

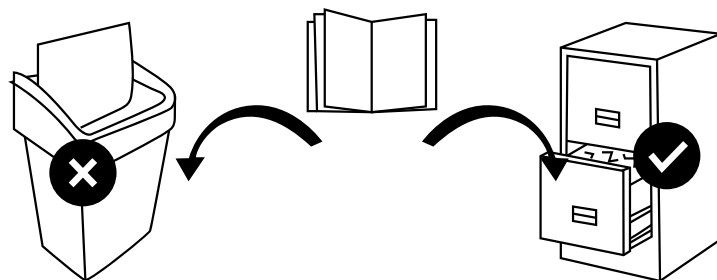
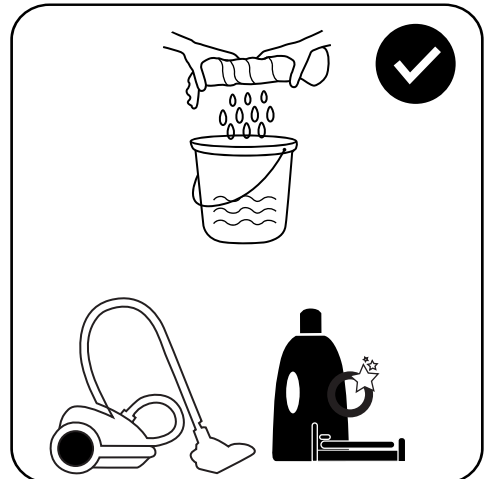
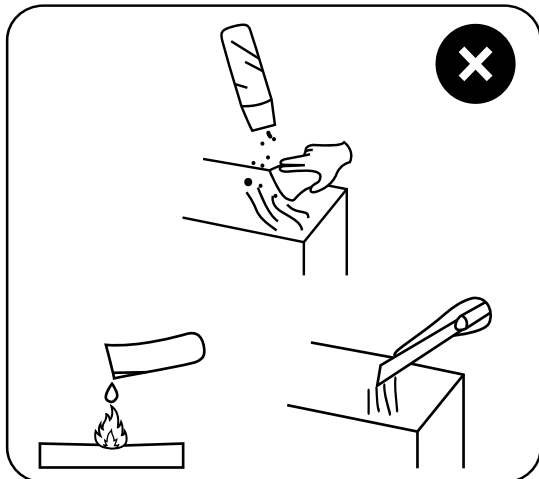

FOR TIPS ON HOW TO CARE FOR YOUR PIECE

Please refer to our Care & Maintenance Guide in stores and online